

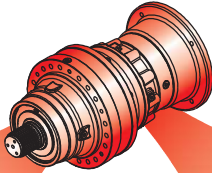

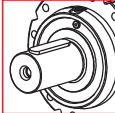

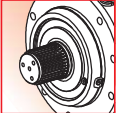





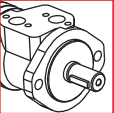
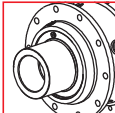
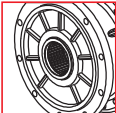
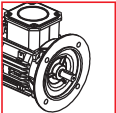
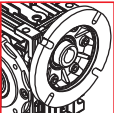
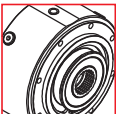
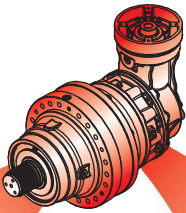
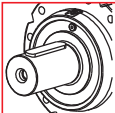
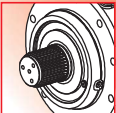

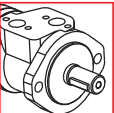
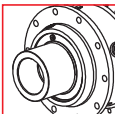
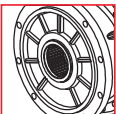
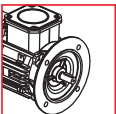
TEKNİK VERİLER / TECHNICAL DATA / TECHNISCHE DATEN / DATI TECNICI / DONNÉES TECHNIQUES / DATOS TÉCNICAS

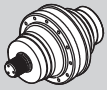
	$i_{ges}$	$M_{2max}$ (n1: 1400rpm) (Nm)				
			OUTPUT		INPUT	
1001	3.56 ... 8.67	470	 Ø42	 40X36 DIN 5482	 Ø28 - Ø42 1 3/8 Z6	 Hydraulic Motor
1002	12.6 ... 58.5	660	 Ø50	 40X36 DIN 5482	 Electric Motor	 Worm gearboxes
1003	54.2 ... 394.9	940				
1004	337.4 ... 3422.2	1340			 Brake	

	$i_{ges}$	$M_{2max}$ (n1: 1400rpm) (Nm)				
			OUTPUT		INPUT	
1002	10.4 ... 19.8	570	 Ø42	 40X36 DIN 5482	 Ø28 - Ø42 1 3/8 Z6	 Hydraulic Motor
1003	37.1 ... 171.6	800	 Ø50	 40X36 DIN 5482	 Electric Motor	
1004	131.8 ... 1487.2	1140			 Brake	

	Pt [kW]	n <sub>1max</sub> [min <sup>-1</sup> ]	i <sub>ges</sub>	Mc [kNm]				Giriş - Input - Antrieb - Entrata - Entrée - Entrada		
				n <sub>2</sub> x h	n <sub>2</sub> x h	n <sub>2</sub> x h	n <sub>2</sub> x h			
				10.000	20.000	50.000	100.000	IEC (B5)	PMRV / PRV	EL - EML EM - EP - ET
PL 1001	12	2800	3.56	1.26	1.12	0.96	0.85	63   100 71   112 80   132 90   160	050 063 075 090	EL C 28 EL C 42 EML 42 EML 1"3/8 Z6
			4.29	1.26	1.12	0.96	0.85			
			5.60	0.92	0.82	0.69	0.61			
			6.75	0.81	0.71	0.61	0.54			
			8.67	0.52	0.46	0.39	0.35			
PL 1002	8	2800	12.6	1.26	1.12	0.96	0.85	63 71 80 90 100 112 132	050 063 075 090	EL C 28 EL C 42 EML 42 EML 1"3/8 Z6
			15.2	1.26	1.12	0.96	0.85			
			19.9	1.26	1.12	0.96	0.85			
			24.0	1.26	1.12	0.96	0.85			
			28.9	1.26	1.12	0.96	0.85			
			31.4	0.92	0.82	0.69	0.61			
			37.8	0.92	0.82	0.69	0.61			
			45.6	0.81	0.71	0.61	0.54			
			58.5	0.81	0.71	0.61	0.54			
PL 1003	5	2800	54.2	1.26	1.12	0.96	0.85	63 71 80 90 100 112 132	050 063 075 090	EL C 28 EL C 42 EML 42 EML 1"3/8 Z6
			65.3	1.26	1.12	0.96	0.85			
			70.8	1.26	1.12	0.96	0.85			
			78.7	1.26	1.12	0.96	0.85			
			85.3	1.26	1.12	0.96	0.85			
			102.9	1.26	1.12	0.96	0.85			
			111.5	1.26	1.12	0.96	0.85			
			134.4	1.26	1.12	0.96	0.85			
			162.0	1.26	1.12	0.96	0.85			
			172.6	1.26	1.12	0.96	0.85			
			208.0	1.26	1.12	0.96	0.85			
			211.7	0.92	0.82	0.69	0.61			
			255.2	0.92	0.82	0.69	0.61			
			271.8	0.92	0.82	0.69	0.61			
			307.5	0.81	0.71	0.61	0.54			
			327.6	0.92	0.82	0.69	0.61			
			394.9	0.81	0.71	0.61	0.54			
PL 1004	1.5	2800	337.4	1.26	1.12	0.96	0.85	63 71 80 90	050 063 075 090	EL C 28 EL C 42 EML 42 EML 1"3/8 Z6
			365.7	1.26	1.12	0.96	0.85			
			396.4	1.26	1.12	0.96	0.85			
			440.8	1.26	1.12	0.96	0.85			
			477.9	1.26	1.12	0.96	0.85			
			531.3	1.26	1.12	0.96	0.85			
			576.0	1.26	1.12	0.96	0.85			
			624.4	1.26	1.12	0.96	0.85			
			694.3	1.26	1.12	0.96	0.85			
			752.6	1.26	1.12	0.96	0.85			
			836.9	1.26	1.12	0.96	0.85			
			907.2	1.26	1.12	0.96	0.85			
			966.3	1.26	1.12	0.96	0.85			
			1093.5	1.26	1.12	0.96	0.85			
			1144.5	1.26	1.12	0.96	0.85			
			1185.4	0.92	0.82	0.69	0.61			
			1318.1	1.26	1.12	0.96	0.85			
			1428.8	0.92	0.82	0.69	0.61			
			1692.3	1.26	1.12	0.96	0.85			
			3422.2	0.81	0.71	0.61	0.54			

	Pt [kW]	n <sub>1max</sub> [min <sup>-1</sup> ]	i <sub>ges</sub>	Mc [kNm]				Giriş - Input - Antrieb - Entrada - Entrée - Entrada	
				n <sub>2</sub> x h	n <sub>2</sub> x h	n <sub>2</sub> x h	n <sub>2</sub> x h	 IEC (B5)	 EL - EML EM - EP - ET
				10.000	20.000	50.000	100.000		
<b>PLB 1002</b>	8	2800	10.4	1.26	1.12	0.96	0.85	80   112 90   132 100	EL C 28 EL C 42 EML 42 EML 1"3/8 Z6
			12.6	1.26	1.12	0.96	0.85		
			16.4	0.92	0.82	0.69	0.61		
			19.8	0.81	0.71	0.61	0.54		
<b>PLB 1003</b>	5	2800	37.1	1.26	1.12	0.96	0.85	80 90 100 112 132	EL C 28 EL C 42 EML 42 EML 1"3/8 Z6
			44.7	1.26	1.12	0.96	0.85		
			53.9	1.26	1.12	0.96	0.85		
			58.4	1.26	1.12	0.96	0.85		
			70.4	1.26	1.12	0.96	0.85		
			84.9	1.26	1.12	0.96	0.85		
			92.0	0.92	0.82	0.69	0.61		
			110.9	0.92	0.82	0.69	0.61		
			133.6	0.81	0.71	0.61	0.54		
			171.6	0.81	0.71	0.61	0.54		
<b>PLB 1004</b>	1.5	2800	131.8	1.26	1.12	0.96	0.85	80 90	EL C 28 EL C 42 EML 42 EML 1"3/8 Z6
			158.9	1.26	1.12	0.96	0.85		
			191.6	1.26	1.12	0.96	0.85		
			207.7	1.26	1.12	0.96	0.85		
			230.9	1.26	1.12	0.96	0.85		
			301.7	1.26	1.12	0.96	0.85		
			327.1	1.26	1.12	0.96	0.85		
			363.7	1.26	1.12	0.96	0.85		
			394.2	1.26	1.12	0.96	0.85		
			475.2	1.26	1.12	0.96	0.85		
			515.1	0.92	0.82	0.69	0.61		
			572.8	1.26	1.12	0.96	0.85		
			610.1	1.26	1.12	0.96	0.85		
			735.4	1.26	1.12	0.96	0.85		
			797.2	0.92	0.82	0.69	0.61		
			960.9	0.92	0.82	0.69	0.61		
			1158.3	0.81	0.71	0.61	0.54		
			1233.8	0.92	0.82	0.69	0.61		
			1487.2	0.81	0.71	0.61	0.54		



$$M_{\max} = M_c \times 2$$

(n<sub>2</sub> x h = 20.000)

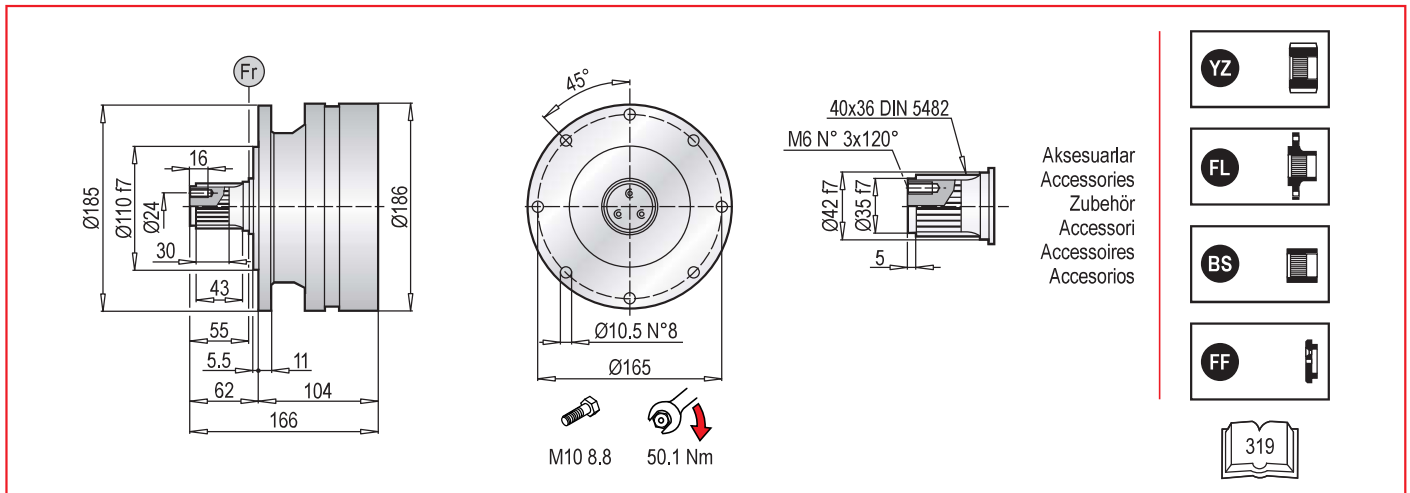

**PL 1000 MS - Elektrik Motor Adaptörleri (IEC) / Electric Motor Couplings (IEC) / Anbauvorrichtung Für Elektromotore (IEC) / Predisposizioni Per Motori Elettrici (IEC) / Adaptations Pour Moteurs Electriques (IEC) / Acoplamientos Para Motores Eléctricos (IEC)**

PL	IEC 63			IEC 71			IEC 80			IEC 90		
	L <sub>T</sub>	Z	ØD	L <sub>T</sub>	Z	ØD	L <sub>T</sub>	Z	ØD	L <sub>T</sub>	Z	ØD
1001	140	36	140	140	36	160	160	56	200	160	56	200
1002	188			188			208			208		
1003	236			236			256			256		
1004	284			284			304			304		

PL	IEC 100			IEC 112			IEC 132			IEC160		
	L <sub>T</sub>	Z	ØD	L <sub>T</sub>	Z	ØD	L <sub>T</sub>	Z	ØD	L <sub>T</sub>	Z	ØD
1001	170	66	250	170	66	250	204	100	300	243	139	350
1002	218			218			252			-	-	-
1003	266			266			300			-	-	-
1004	-	-	-	-	-	-	-	-	-	-	-	-

PL	IEC ~ Kg							
	63	71	80	90	100	112	132	160
1001	19	19	21	21	22	22	26	36
1002	25	25	27	27	28	28	34	-
1003	31	31	33	33	34	34	40	-
1004	37	37	39	39	-	-	-	-

**PL 1000 MS - Giriş Milleri / Input Shafts / Antriebswellen / Alberi Entrata / Arbres D'entree / Ejes De Entrada**

PL	EL C 28				EL C 42				EML 42				EML 1"3/8 Z6			
	L <sub>T</sub>	Z	L	Ød	L <sub>T</sub>	Z	L	Ød	L <sub>T</sub>	Z	L	Ød	L <sub>T</sub>	Z	L	Ød
1001	168	64	50	28	168	64	82	42	198	94	82	42	198	94	106	1"3/8
1002	216				216				246				246			
1003	264				264				294				294			
1004	312				312				342				342			

PL	~ Kg			
	EL C 28	EL C 42	EML 42	EML 1"3/8 Z6
1001	19.5	20.0	23.0	23.0
1002	25.5	26.0	29.0	29.0
1003	31.5	32.0	35.0	35.0
1004	37.5	38.0	41.0	41.0

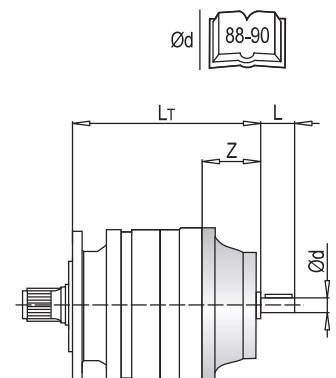
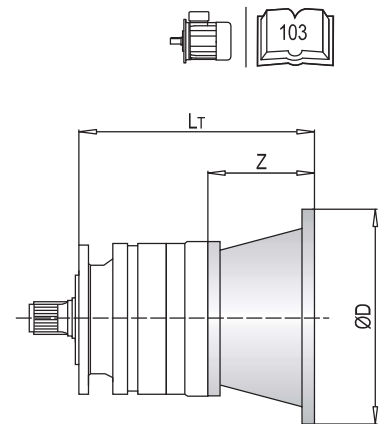

**PL 1000 MS** - Sonsuz Dişli Redüktör Adaptörleri (PMRV/PRV) / Worm Gearbox Adaptors (PMRV/PRV) / Anschluss Für Schneckengetriebe (PMRV/PRV) / Predisposizioni Per Riduttori A Vite Senza Fine (PMRV/PRV) / Adaptation Pour Reducteurs A Vis Sans Fin (PMRV/PRV) / Acoplamiento Para Reductores De Tornillo Sin Fin (PMRV/PRV)

PL	PMRV/PRV 050					PMRV/PRV 063				
	L <sub>M</sub>	I	h	MA	G	L <sub>M</sub>	I	h	MA	G
1001	229.5	50	110	60	80	239	63	135	72	95
1002	277.5					287				
1003	325.5					335				
1004	373.5					383				

PL	PMRV/PRV 075					PMRV/PRV 090				
	L <sub>M</sub>	I	h	MA	G	L <sub>M</sub>	I	h	MA	G
1001	218	75	161	86	112.5	228	90	193	103	129.5
1002	266					276				
1004	314					324				
1004	362					372				

PL	PMRV/PRV ~ Kg			
	050	063	075	090
1001	22	25.5	28	33
1002	28	31.5	34	39
1004	34	37.5	40	45
1004	40	43.5	46	51

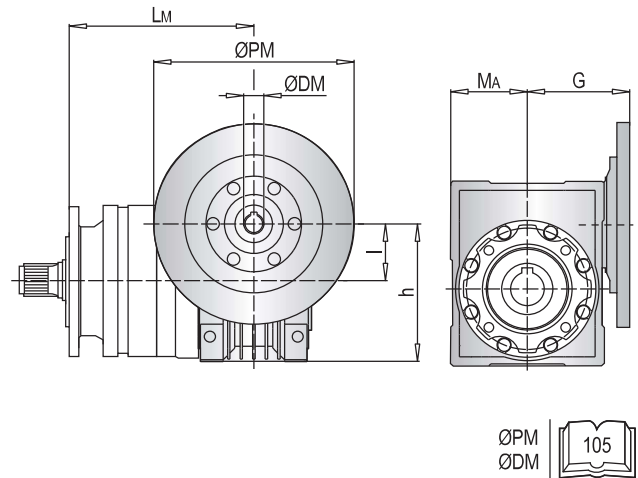

**PLB 1000 MS** - Elektrik Motor Adaptörleri (IEC) / Electric Motor Couplings (IEC) / Anbauvorrichtung Für Elektromotore (IEC) / Predisposizioni Per Motori Elettrici (IEC) / Adaptations Pour Moteurs Electriques (IEC) / Acoplamientos Para Motores Eléctricos (IEC)

PLB	IEC 80				IEC 90				IEC 100				IEC 112			
	A	L <sub>T</sub>	Z	ØD	A	L <sub>T</sub>	Z	ØD	A	L <sub>T</sub>	Z	ØD	A	L <sub>T</sub>	Z	ØD
1002	179	216	56	200	179	216	56	200	179	226	66	250	179	226	66	250
1003	227				227				227				227			
1004	275				275				-				-			

PLB	IEC 132			
	A	L <sub>T</sub>	Z	ØD
1002	179	260	100	300
1003	227			
1004	-			

PLB	IEC ~ Kg				
	80	90	100	112	132
1002	36	36	37	37	41
1003	42	42	43	43	47
1004	48	48	-	-	-

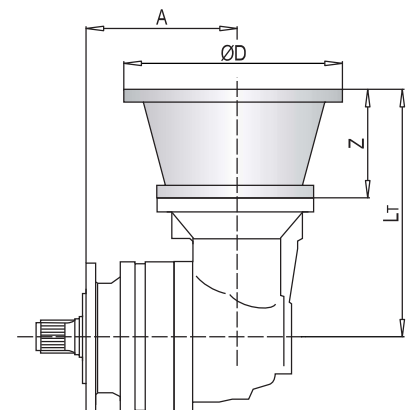

**PLB 1000 MS** - Giriş Milleri / Input Shafts / Antriebswellen / Alberi Entrata / Arbres D'entree / Ejes De Entrada

PLB	EL C 28					EL C 42					EML 42					EML 1"3/8 Z6				
	A	L <sub>T</sub>	Z	L	Ød	A	L <sub>T</sub>	Z	L	Ød	A	L <sub>T</sub>	Z	L	Ød	A	L <sub>T</sub>	Z	L	Ød
1002	179	224	64	50	28	179	224	64	82	42	179	254	94	82	42	179	254	94	106	1"3/8
1003	227					227					227					227				
1004	275					275					275					275				

PLB	~ Kg			
	EL C 28	EL C 42	EML 42	EML 1"3/8 Z6
1002	34.5	35.0	38.0	38.0
1003	40.5	41.0	44.0	44.0
1004	46.5	47.0	50.0	50.0

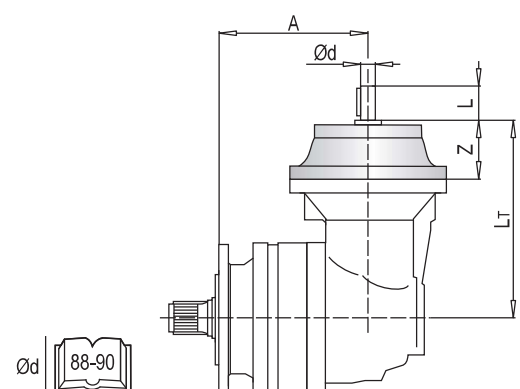

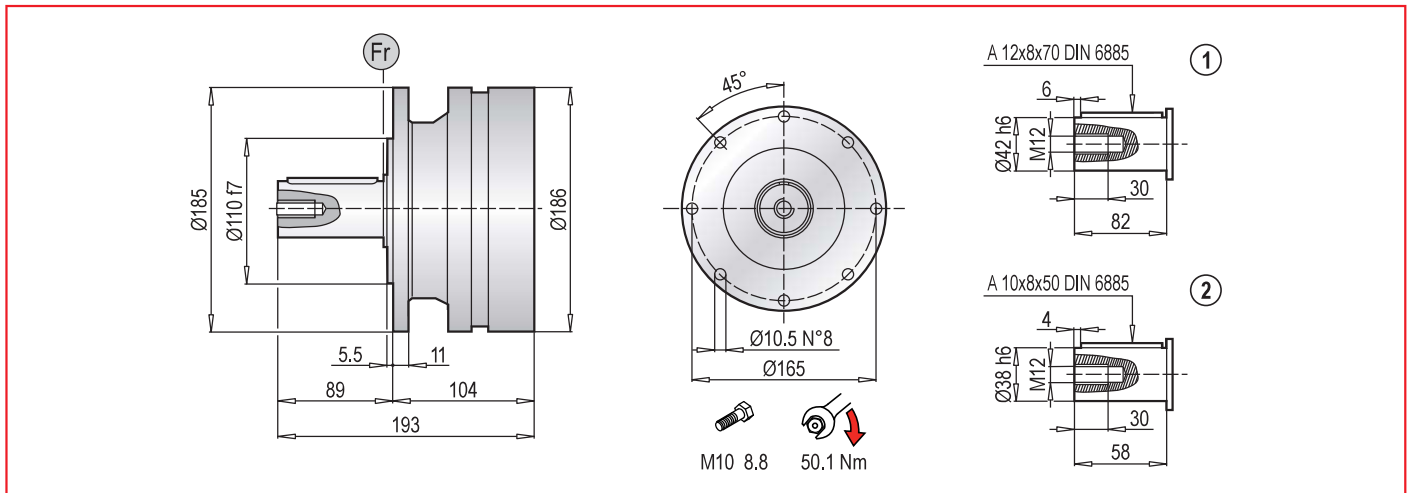

**PL 1000 MC - Elektrik Motor Adaptörleri (IEC) / Electric Motor Couplings (IEC) / Anbauvorrichtung Für Elektromotore (IEC) / Predisposizioni Per Motori Elettrici (IEC) / Adaptations Pour Moteurs Electriques (IEC) / Acoplamientos Para Motores Eléctricos (IEC)**

PL	IEC 63			IEC 71			IEC 80			IEC 90		
	L <sub>T</sub>	Z	ØD	L <sub>T</sub>	Z	ØD	L <sub>T</sub>	Z	ØD	L <sub>T</sub>	Z	ØD
1001	140	36	140	140	36	160	160	56	200	160	56	200
1002	188			188			208			208		
1003	236			236			256			256		
1004	284			284			304			304		

PL	IEC 100			IEC 112			IEC 132			IEC 160		
	L <sub>T</sub>	Z	ØD	L <sub>T</sub>	Z	ØD	L <sub>T</sub>	Z	ØD	L <sub>T</sub>	Z	ØD
1001	170	66	250	170	66	250	204	100	300	243	139	350
1002	218			218			252			-	-	-
1003	266			266			300			-	-	-
1004	-	-	-	-	-	-	-	-	-	-	-	-

PL	IEC ~ Kg							
	63	71	80	90	100	112	132	160
1001	19	19	21	21	22	22	26	36
1002	25	25	27	27	28	28	34	-
1003	31	31	33	33	34	34	40	-
1004	37	37	39	39	-	-	-	-

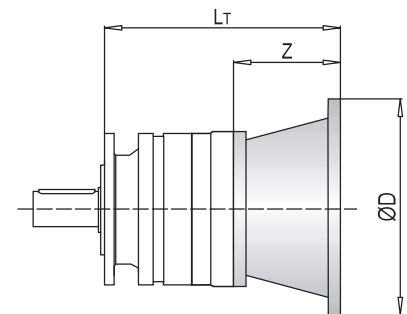

**PL 1000 MC - Giriş Milleri / Input Shafts / Antriebswellen / Alberi Entrata / Arbres D'entree / Ejes De Entrada**

PL	EL C 28				EL C 42				EML 42				EML 1"3/8 Z6			
	L <sub>T</sub>	Z	L	Ød	L <sub>T</sub>	Z	L	Ød	L <sub>T</sub>	Z	L	Ød	L <sub>T</sub>	Z	L	Ød
1001	168	64	50	28	168	64	82	42	198	94	82	42	198	94	106	1"3/8
1002	216				216				246				246			
1003	264				264				294				294			
1004	312				312				342				342			

PL	~ Kg			
	EL C 28	EL C 42	EML 42	EML 1"3/8 Z6
1001	19.5	20.0	23.0	23.0
1002	25.5	26.0	29.0	29.0
1003	31.5	32.0	35.0	35.0
1004	37.5	38.0	41.0	41.0

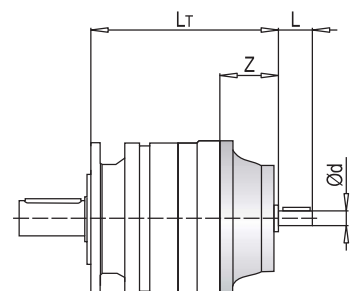

**PL 1000 MC -** Sonsuz Dişlili Redüktör Adaptörleri (PMRV/PRV) / Worm Gearbox Adaptors (PMRV/PRV) / Anschluss Für Schneckengetriebe (PMRV/PRV) / Predisposizioni Per Riduttori A Vite Senza Fine (PMRV/PRV) / Adaptation Pour Reducteurs A Vis Sans Fin (PMRV/PRV) / Acoplamiento Para Reductores De Tornillo Sin Fin (PMRV/PRV)

PL	PMRV/PRV 050					PMRV/PRV 063				
	L <sub>M</sub>	I	h	MA	G	L <sub>M</sub>	I	h	MA	G
1001	229.5	50	110	60	80	239	63	135	72	95
1002	277.5					287				
1003	325.5					335				
1004	373.5					383				

PL	PMRV/PRV 075					PMRV/PRV 090				
	L <sub>M</sub>	I	h	MA	G	L <sub>M</sub>	I	h	MA	G
1001	218	75	161	86	112.5	228	90	193	103	129.5
1002	266					276				
1004	314					324				
1004	362					372				

PL	PMRV/PRV ~ Kg			
	050	063	075	090
1001	22	25.5	28	33
1002	28	31.5	34	39
1004	34	37.5	40	45
1004	40	43.5	46	51

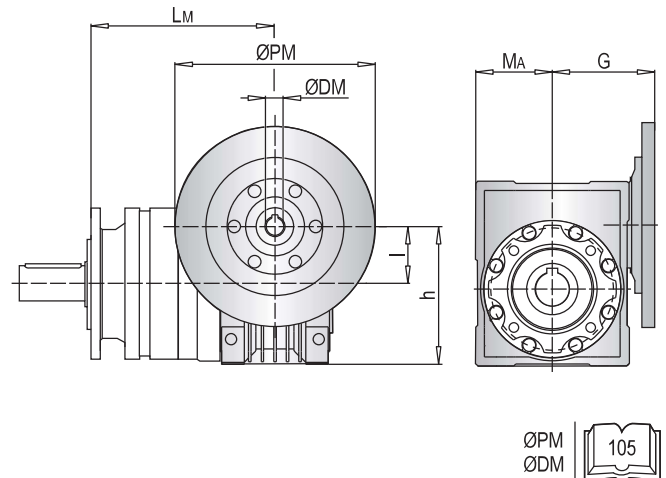

**PLB 1000 MC -** Elektrik Motor Adaptörleri (IEC) / Electric Motor Couplings (IEC) / Anbauvorrichtung Für Elektromotore (IEC) / Predisposizioni Per Motori Elettrici (IEC) / Adaptations Pour Moteurs Electriques (IEC) / Acoplamientos Para Motores Eléctricos (IEC)

PLB	IEC 80				IEC 90				IEC 100				IEC 112			
	A	L <sub>T</sub>	Z	ØD	A	L <sub>T</sub>	Z	ØD	A	L <sub>T</sub>	Z	ØD	A	L <sub>T</sub>	Z	ØD
1002	179	216	56	200	179	216	56	200	179	226	66	250	179	226	66	250
1003	227				227				227				227			
1004	275				275				-				-			

PLB	IEC 132			
	A	L <sub>T</sub>	Z	ØD
1002	179	260	100	300
1003	227			
1004	-			

PLB	IEC ~ Kg				
	80	90	100	112	132
1002	36	36	37	37	41
1003	42	42	43	43	47
1004	48	48	-	-	-

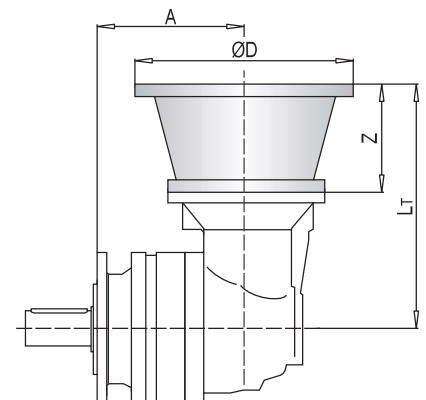

**PLB 1000 MC -** Giriş Milleri / Input Shafts / Antriebswellen / Alberi Entrata / Arbres D'entree / Ejes De Entrada

PLB	EL C 28					EL C 42					EML 42					EML 1"3/8 Z6				
	A	L <sub>T</sub>	Z	L	Ød	A	L <sub>T</sub>	Z	L	Ød	A	L <sub>T</sub>	Z	L	Ød	A	L <sub>T</sub>	Z	L	Ød
1002	179	224	64	50	28	179	224	64	82	42	179	254	94	82	42	179	254	94	106	1"3/8
1003	227					227					227					227				
1004	275					275					275					275				

PLB	~ Kg			
	EL C 28	EL C 42	EML 42	EML 1"3/8 Z6
1002	34.5	35.0	38.0	38.0
1003	40.5	41.0	44.0	44.0
1004	46.5	47.0	50.0	50.0

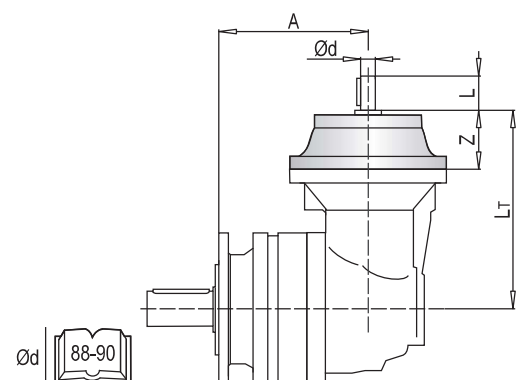

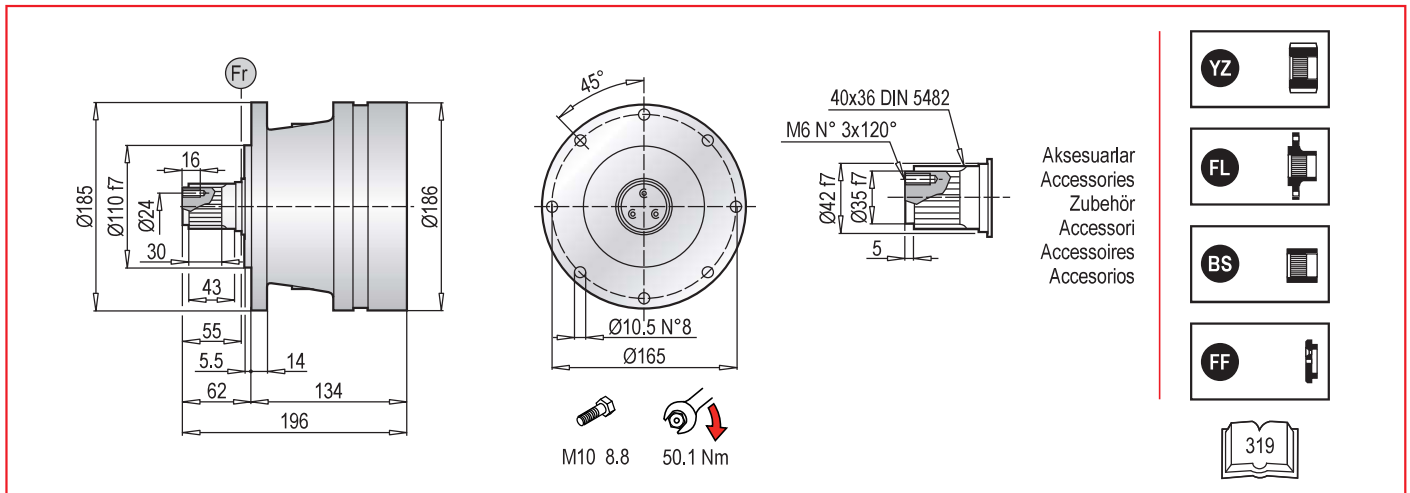

**PL 1000 PS** - Elektrik Motor Adaptörleri (IEC) / Electric Motor Couplings (IEC) / Anbauvorrichtung Für Elektromotore (IEC) / Predisposizioni Per Motori Elettrici (IEC) / Adaptations Pour Moteurs Electriques (IEC) / Acoplamientos Para Motores Eléctricos (IEC)

PL	IEC 63			IEC 71			IEC 80			IEC 90		
	L <sub>T</sub>	Z	ØD	L <sub>T</sub>	Z	ØD	L <sub>T</sub>	Z	ØD	L <sub>T</sub>	Z	ØD
1001	170	36	140	170	36	160	190	56	200	190	56	200
1002	218			218			238			238		
1003	266			266			286			286		
1004	314			314			334			334		

PL	IEC 100			IEC 112			IEC 132			IEC 160		
	L <sub>T</sub>	Z	ØD	L <sub>T</sub>	Z	ØD	L <sub>T</sub>	Z	ØD	L <sub>T</sub>	Z	ØD
1001	200	66	250	200	66	250	234	100	300	273	139	350
1002	248			248			282			-	-	-
1003	296			296			330			-	-	-
1004	-			-			-			-	-	-

PL	IEC ~ Kg							
	63	71	80	90	100	112	132	160
1001	21	21	23	23	24	24	28	38
1002	27	27	29	29	30	30	34	-
1003	33	33	35	35	36	36	40	-
1004	39	39	41	41	-	-	-	-

**PL 1000 PS** - Giriş Milleri / Input Shafts / Antriebswellen / Alberi Entrata / Arbres D'entree / Ejes De Entrada

PL	EL C 28				EL C 42				EML 42				EML 1"3/8 Z6			
	L <sub>T</sub>	Z	L	Ød	L <sub>T</sub>	Z	L	Ød	L <sub>T</sub>	Z	L	Ød	L <sub>T</sub>	Z	L	Ød
1001	198	64	50	28	198	64	82	42	228	94	82	42	228	94	106	1"3/8
1002	246				246				276				276			
1003	294				294				324				324			
1004	342				342				372				372			

PL	~ Kg			
	EL C 28	EL C 42	EML 42	EML 1"3/8 Z6
1001	19.5	20.0	23.0	23.0
1002	25.5	26.0	29.0	29.0
1003	31.5	32.0	35.0	35.0
1004	37.5	38.0	41.0	41.0

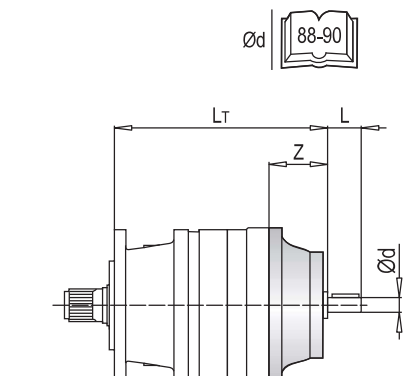
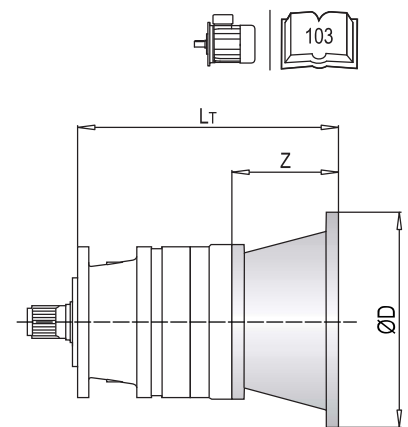



**PL 1000 PS - Sonsuz Dişli Redüktör Adaptörleri (PMRV/PRV) / Worm Gearbox Adaptors (PMRV/PRV) / Anschluss Für Schneckengetriebe (PMRV/PRV) / Predisposizioni Per Riduttori A Vite Senza Fine (PMRV/PRV) / Adaptation Pour Reducteurs A Vis Sans Fin (PMRV/PRV) / Acoplamiento Para Reductores De Tornillo Sin Fin (PMRV/PRV)**

PL	PMRV/PRV 050					PMRV/PRV 063				
	L <sub>M</sub>	I	h	MA	G	L <sub>M</sub>	I	h	MA	G
1001	259.5	50	110	60	80	269	63	135	72	95
1002	307.5					317				
1003	355.5					365				
1004	403.5					413				

PL	PMRV/PRV 075					PMRV/PRV 090				
	L <sub>M</sub>	I	h	MA	G	L <sub>M</sub>	I	h	MA	G
1001	248	75	161	86	112.5	258	90	193	103	129.5
1002	296					306				
1004	344					354				
1004	392					402				

PL	PMRV/PRV ~ Kg			
	050	063	075	090
1001	24	27.5	30	35
1002	30	33.5	36	41
1004	36	39.5	42	47
1004	42	45.5	48	53

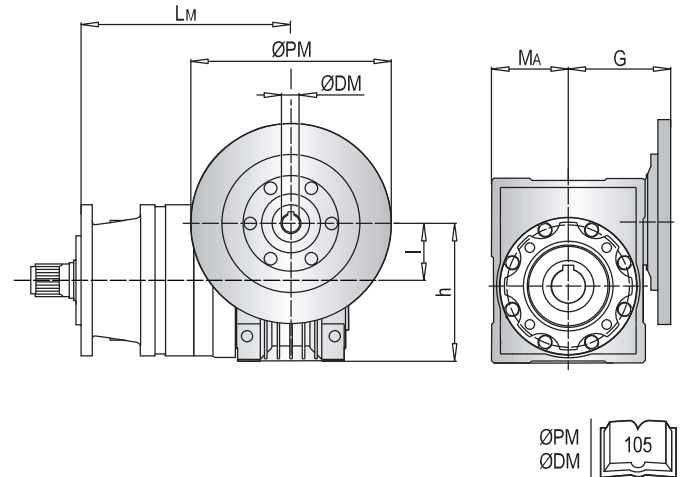

**PLB 1000 PS - Elektrik Motor Adaptörleri (IEC) / Electric Motor Couplings (IEC) / Anbauvorrichtung Für Elektromotore (IEC) / Predisposizioni Per Motori Elettrici (IEC) / Adaptations Pour Moteurs Electriques (IEC) / Acoplamientos Para Motores Eléctricos (IEC)**

PLB	IEC 80				IEC 90				IEC 100				IEC 112			
	A	L <sub>T</sub>	Z	ØD	A	L <sub>T</sub>	Z	ØD	A	L <sub>T</sub>	Z	ØD	A	L <sub>T</sub>	Z	ØD
1002	209	216	56	200	209	216	56	200	209	226	66	250	209	226	66	250
1003	257				257				257				257			
1004	305				305				-				-			

PLB	IEC 132			
	A	L <sub>T</sub>	Z	ØD
1002	209	260	100	300
1003	257			
1004	-			

PLB	IEC ~ Kg				
	80	90	100	112	132
1002	38	38	39	39	43
1003	44	44	45	45	49
1004	50	50	-	-	-

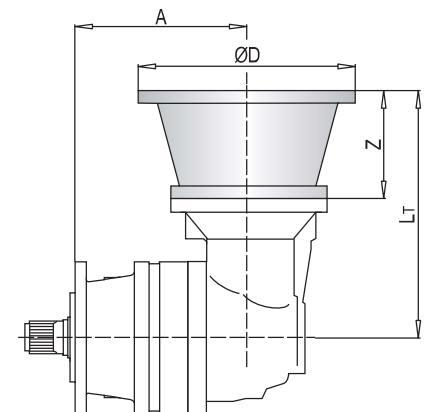

**PLB 1000 PS - Giriş Milleri / Input Shafts / Antriebswellen / Alberi Entrata / Arbres D'entree / Ejes De Entrada**

PLB	EL C 28					EL C 42					EML 42					EML 1"3/8 Z6				
	A	L <sub>T</sub>	Z	L	Ød	A	L <sub>T</sub>	Z	L	Ød	A	L <sub>T</sub>	Z	L	Ød	A	L <sub>T</sub>	Z	L	Ød
1002	209	224	64	50	28	209	224	64	82	42	209	254	94	82	42	209	254	94	106	1"3/8
1003	257					257					257					257				
1004	305					305					305					305				

PLB	~ Kg			
	EL C 28	EL C 42	EML 42	EML 1"3/8 Z6
1002	34.5	35.0	38.0	38.0
1003	40.5	41.0	44.0	44.0
1004	46.5	47.0	50.0	50.0

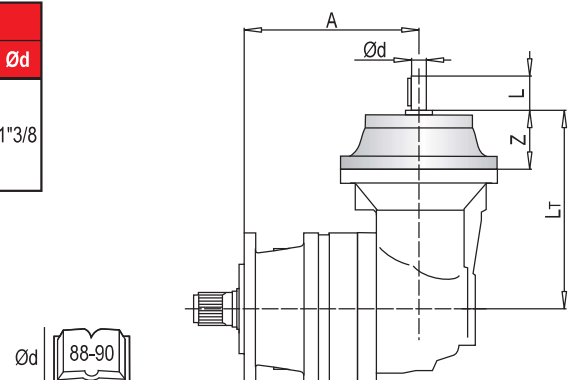

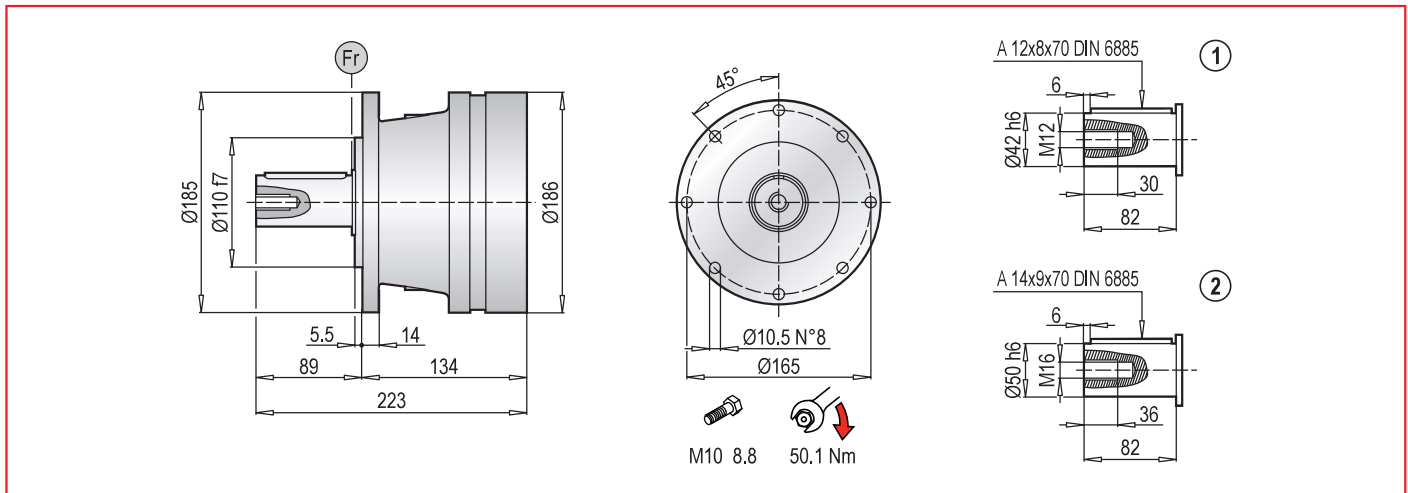

**PL 1000 PC** - Elektrik Motor Adaptörleri (IEC) / Electric Motor Couplings (IEC) / Anbauvorrichtung Für Elektromotore (IEC) / Predisposizioni Per Motori Elettrici (IEC) / Adaptations Pour Moteurs Electriques (IEC) / Acoplamientos Para Motores Eléctricos (IEC)

PL	IEC 63			IEC 71			IEC 80			IEC 90		
	L <sub>T</sub>	Z	ØD	L <sub>T</sub>	Z	ØD	L <sub>T</sub>	Z	ØD	L <sub>T</sub>	Z	ØD
1001	170	36	140	170	36	160	190	56	200	190	56	200
1002	218			218			238			238		
1003	266			266			286			286		
1004	314			314			334			334		

PL	IEC 100			IEC 112			IEC 132			IEC 160		
	L <sub>T</sub>	Z	ØD	L <sub>T</sub>	Z	ØD	L <sub>T</sub>	Z	ØD	L <sub>T</sub>	Z	ØD
1001	200	66	250	200	66	250	234	100	300	273	139	350
1002	248			248			282			-	-	-
1003	296			296			330			-	-	-
1004	-	-	-	-	-	-	-	-	-	-	-	-

PL	IEC ~ Kg								
	63	71	80	90	100	112	132	160	
1001	21	21	23	23	24	24	28	38	
1002	27	27	29	29	30	30	34	-	
1003	33	33	35	35	36	36	40	-	
1004	39	39	41	41	-	-	-	-	

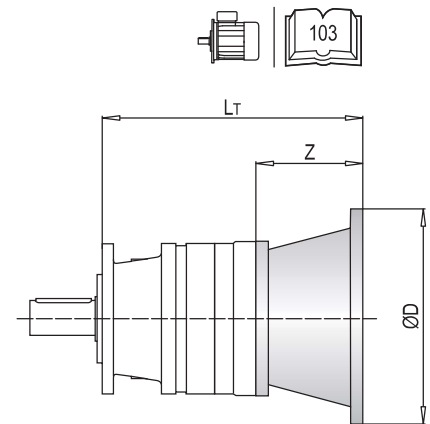

**PL 1000 PC** - Giriş Milleri / Input Shafts / Antriebswellen / Alberi Entrata / Arbres D'entree / Ejes De Entrada

PL	EL C 28				EL C 42				EML 42				EML 1"3/8 Z6			
	L <sub>T</sub>	Z	L	Ød	L <sub>T</sub>	Z	L	Ød	L <sub>T</sub>	Z	L	Ød	L <sub>T</sub>	Z	L	Ød
1001	198	64	50	28	198	64	82	42	228	94	82	42	228	94	106	1"3/8
1002	246				246				276				276			
1003	294				294				324				324			
1004	342				342				372				372			

PL	~ Kg			
	EL C 28	EL C 42	EML 42	EML 1"3/8 Z6
1001	19.5	20.0	23.0	23.0
1002	25.5	26.0	29.0	29.0
1003	31.5	32.0	35.0	35.0
1004	37.5	38.0	41.0	41.0

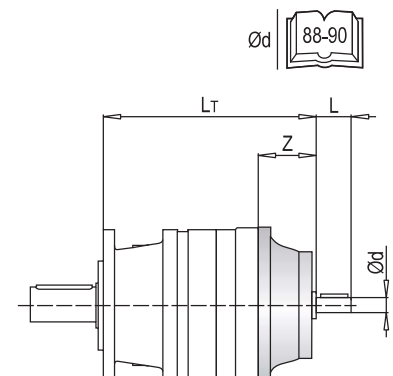

**PL 1000 PC** - Sonsuz Dişlili Redüktör Adaptörleri (PMRV/PRV) / Worm Gearbox Adaptors (PMRV/PRV) / Anschluss Für Schneckengetriebe (PMRV/PRV) / Predisposizioni Per Riduttori A Vite Senza Fine (PMRV/PRV) / Adaptation Pour Reducteurs A Vis Sans Fin (PMRV/PRV) / Acoplamiento Para Reductores De Tornillo Sin Fin (PMRV/PRV)

PL	PMRV/PRV 050					PMRV/PRV 063				
	L <sub>M</sub>	I	h	MA	G	L <sub>M</sub>	I	h	MA	G
1001	259.5	50	110	60	80	269	63	135	72	95
1002	307.5					317				
1003	355.5					365				
1004	403.5					413				

PL	PMRV/PRV 075					PMRV/PRV 090				
	L <sub>M</sub>	I	h	MA	G	L <sub>M</sub>	I	h	MA	G
1001	248	75	161	86	112.5	258	90	193	103	129.5
1002	296					306				
1003	344					354				
1004	392					402				

PL	PMRV/PRV ~ Kg			
	050	063	075	090
1001	24	27.5	30	35
1002	30	33.5	36	41
1003	36	39.5	42	47
1004	42	45.5	48	53

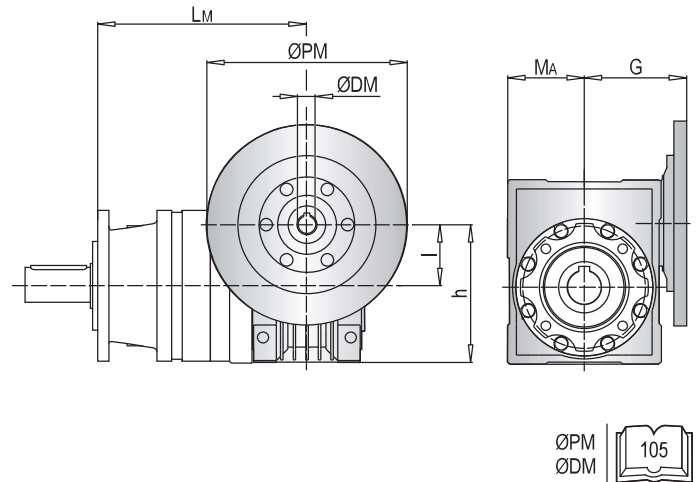

**PLB 1000 PC** - Elektrik Motor Adaptörleri (IEC) / Electric Motor Couplings (IEC) / Anbauvorrichtung Für Elektromotore (IEC) / Predisposizioni Per Motori Elettrici (IEC) / Adaptations Pour Moteurs Electriques (IEC) / Acoplamientos Para Motores Eléctricos (IEC)

PLB	IEC 80				IEC 90				IEC 100				IEC 112			
	A	L <sub>T</sub>	Z	ØD	A	L <sub>T</sub>	Z	ØD	A	L <sub>T</sub>	Z	ØD	A	L <sub>T</sub>	Z	ØD
1002	209	216	56	200	209	216	56	200	209	226	66	250	209	226	66	250
1003	257				257				257				257			
1004	305				305				-				-			

PLB	IEC 132			
	A	L <sub>T</sub>	Z	ØD
1002	209	260	100	300
1003	257			
1004	-			

PLB	IEC ~ Kg				
	80	90	100	112	132
1002	38	38	39	39	43
1003	44	44	45	45	49
1004	50	50	-	-	-

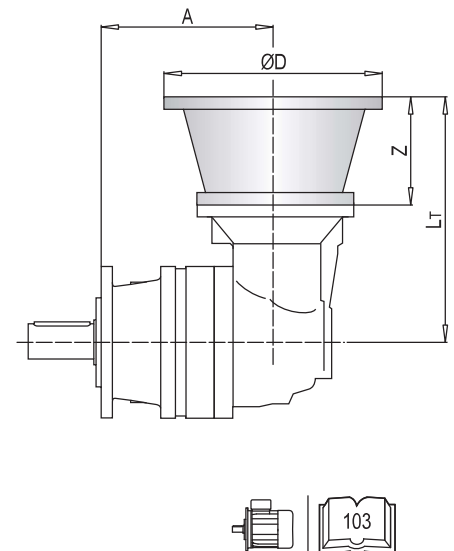

**PLB 1000 PC** - Giriş Milleri / Input Shafts / Antriebswellen / Alberi Entrata / Arbres D'entree / Ejes De Entrada

PLB	EL C 28					EL C 42					EML 42					EML 1"3/8 Z6				
	A	L <sub>T</sub>	Z	L	Ød	A	L <sub>T</sub>	Z	L	Ød	A	L <sub>T</sub>	Z	L	Ød	A	L <sub>T</sub>	Z	L	Ød
1002	209	224	64	50	28	209	224	64	82	42	209	254	94	82	42	209	254	94	106	1"3/8
1003	257					257					257					257				
1004	305					305					305					305				

PLB	~ Kg			
	EL C 28	EL C 42	EML 42	EML 1"3/8 Z6
1002	34.5	35.0	38.0	38.0
1003	40.5	41.0	44.0	44.0
1004	46.5	47.0	50.0	50.0

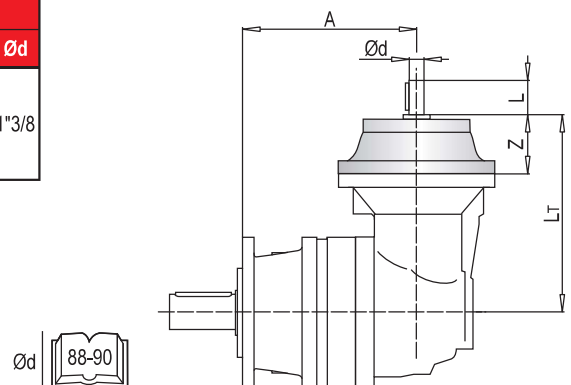

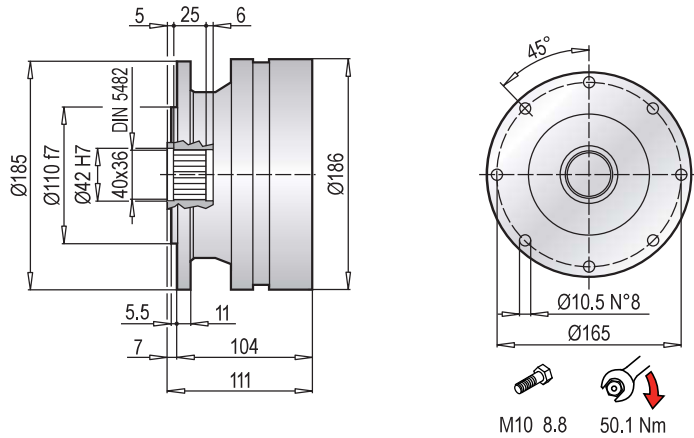

Aksesuarlar  
Accessories  
Zubehör  
Accessori  
Accessoires  
Accesorios



**PL 1000 F - Elektrik Motor Adaptörleri (IEC) / Electric Motor Couplings (IEC) / Anbauvorrichtung Für Elektromotore (IEC) / Predisposizioni Per Motori Elettrici (IEC) / Adaptations Pour Moteurs Electriques (IEC) / Acoplamientos Para Motores Eléctricos (IEC)**

PL	IEC 63			IEC 71			IEC 80			IEC 90		
	L <sub>T</sub>	Z	ØD	L <sub>T</sub>	Z	ØD	L <sub>T</sub>	Z	ØD	L <sub>T</sub>	Z	ØD
1001	140	36	140	140	36	160	160	56	200	160	56	200
1002	188			188			208			208		
1003	236			236			256			256		
1004	284			284			304			304		

PL	IEC 100			IEC 112			IEC 132			IEC 160		
	L <sub>T</sub>	Z	ØD	L <sub>T</sub>	Z	ØD	L <sub>T</sub>	Z	ØD	L <sub>T</sub>	Z	ØD
1001	170	66	250	170	66	250	204	100	300	243	139	350
1002	218			218			252			-	-	-
1003	266			266			300			-	-	-
1004	-	-	-	-	-	-	-	-	-	-	-	-

PL	IEC ~							
	63	71	80	90	100	112	132	160
1001	17	17	19	19	20	20	24	34
1002	23	23	25	25	26	26	30	-
1003	29	29	31	31	32	32	36	-
1004	35	35	37	37	-	-	-	-

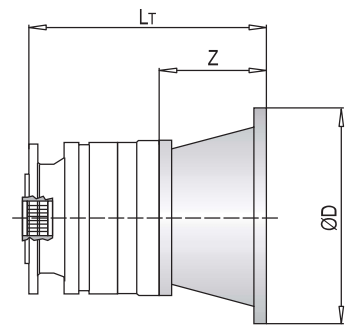

**PL 1000 F - Giriş Milleri / Input Shafts / Antriebswellen / Alberi Entrata / Arbres D'entree / Ejes De Entrada**

PL	EL C 28				EL C 42				EML 42				EML 1"3/8 Z6			
	L <sub>T</sub>	Z	L	Ød	L <sub>T</sub>	Z	L	Ød	L <sub>T</sub>	Z	L	Ød	L <sub>T</sub>	Z	L	Ød
1001	168	64	50	28	168	64	82	42	198	94	82	42	198	94	106	1"3/8
1002	216				216				246				246			
1003	264				264				294				294			
1004	312				312				342				342			

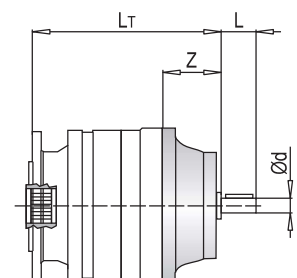

PL	~			
	EL C 28	EL C 42	EML 42	EML 1"3/8 Z6
1001	17.5	18.0	21.0	21.0
1002	23.5	24.0	27.0	27.0
1003	29.5	30.0	33.0	33.0
1004	35.5	36.0	39.0	39.0

**PL 1000 F - Sonsuz Dişli Redüktör Adaptörleri (PMRV/PRV) / Worm Gearbox Adaptors (PMRV/PRV) / Anschluss Für Schneckengetriebe (PMRV/PRV) / Predisposizioni Per Riduttori A Vite Senza Fine (PMRV/PRV) / Adaptation Pour Reducteurs A Vis Sans Fin (PMRV/PRV) / Acoplamiento Para Reductores De Tornillo Sin Fin (PMRV/PRV)**

PL	PMRV/PRV 050					PMRV/PRV 063				
	L <sub>M</sub>	I	h	MA	G	L <sub>M</sub>	I	h	MA	G
1001	229.5	50	110	60	80	239	63	135	72	95
1002	277.5					287				
1003	325.5					335				
1004	373.5					383				

PL	PMRV/PRV 075					PMRV/PRV 090				
	L <sub>M</sub>	I	h	MA	G	L <sub>M</sub>	I	h	MA	G
1001	218	75	161	86	112.5	228	90	193	103	129.5
1002	266					276				
1003	314					324				
1004	362					372				

PL	PMRV/PRV ~ Kg			
	050	063	075	090
1001	20	23.5	26	31
1002	26	29.5	32	37
1004	32	35.5	38	43
1004	38	41.5	44	49

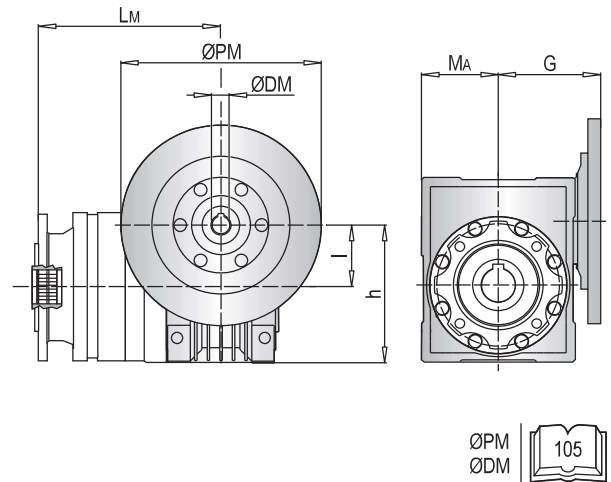

**PLB 1000 F - Elektrik Motor Adaptörleri (IEC) / Electric Motor Couplings (IEC) / Anbauvorrichtung Für Elektromotore (IEC) / Predisposizioni Per Motori Elettrici (IEC) / Adaptations Pour Moteurs Electriques (IEC) / Acoplamientos Para Motores Eléctricos (IEC)**

PLB	IEC 80				IEC 90				IEC 100				IEC 112			
	A	L <sub>T</sub>	Z	ØD	A	L <sub>T</sub>	Z	ØD	A	L <sub>T</sub>	Z	ØD	A	L <sub>T</sub>	Z	ØD
1002	179	216	56	200	179	216	56	200	179	226	66	250	179	226	66	250
1003	227				227				227				227			
1004	275				275											

PLB	IEC 132			
	A	L <sub>T</sub>	Z	ØD
1002	179	260	100	300
1003	227			
1004	-			

PLB	IEC ~ Kg				
	80	90	100	112	132
1002	34	34	35	35	39
1003	40	40	41	41	45
1004	46	46	-	-	-

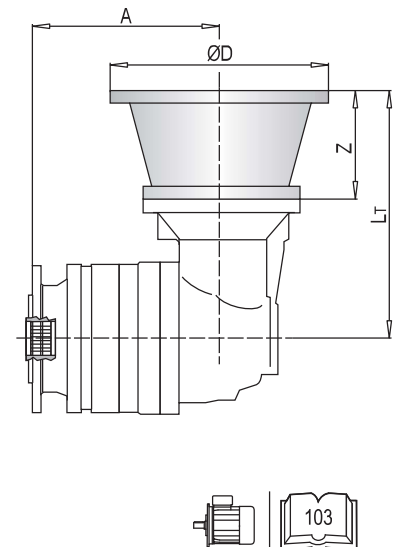

**PLB 1000 F - Giriş Milleri / Input Shafts / Antriebswellen / Alberi Entrata / Arbres D'entree / Ejes De Entrada**

PLB	EL C 28					EL C 42					EML 42					EML 1"3/8 Z6				
	A	L <sub>T</sub>	Z	L	Ød	A	L <sub>T</sub>	Z	L	Ød	A	L <sub>T</sub>	Z	L	Ød	A	L <sub>T</sub>	Z	L	Ød
1002	179	224	64	50	28	179	224	64	82	42	179	254	94	82	42	179	254	94	106	1"3/8
1003	227					227					227					227				
1004	275					275					275					275				

PLB	~ Kg			
	EL C 28	EL C 42	EML 42	EML 1"3/8 Z6
1002	32.5	33.0	36.0	36.0
1003	40.5	41.0	44.0	44.0
1004	46.5	47.0	50.0	50.0

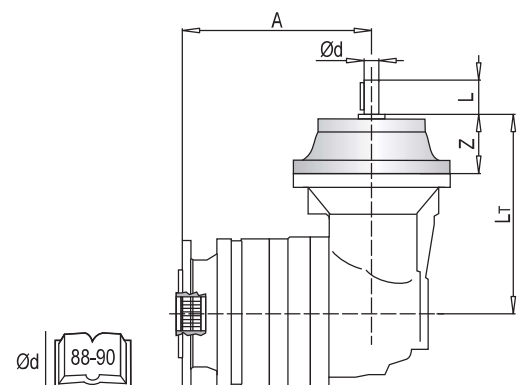

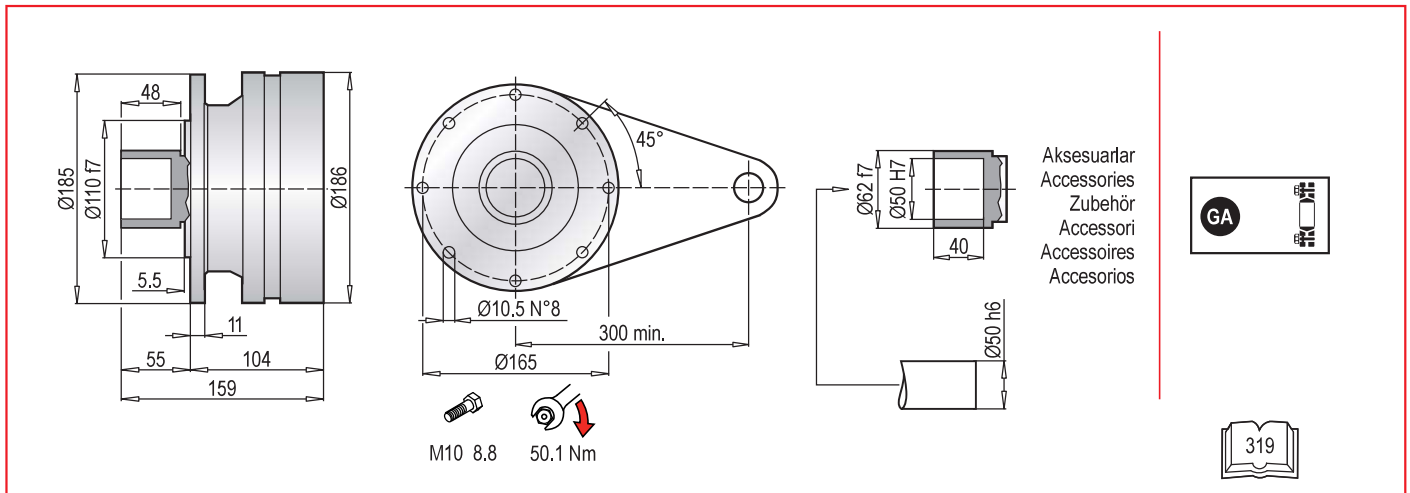

**PL 1000 FS - Elektrik Motor Adaptörleri (IEC) / Electric Motor Couplings (IEC) / Anbauvorrichtung Für Elektromotore (IEC) / Predisposizioni Per Motori Elettrici (IEC) / Adaptations Pour Moteurs Electriques (IEC) / Acoplamientos Para Motores Eléctricos (IEC)**

PL	IEC 63			IEC 71			IEC 80			IEC 90		
	L <sub>T</sub>	Z	ØD	L <sub>T</sub>	Z	ØD	L <sub>T</sub>	Z	ØD	L <sub>T</sub>	Z	ØD
1001	140	36	140	140	36	160	160	56	200	160	56	200
1002	188			188			208			208		
1003	236			236			256			256		
1004	284			284			304			304		

PL	IEC 100			IEC 112			IEC 132			IEC 160		
	L <sub>T</sub>	Z	ØD	L <sub>T</sub>	Z	ØD	L <sub>T</sub>	Z	ØD	L <sub>T</sub>	Z	ØD
1001	170	66	250	170	66	250	204	100	300	243	139	350
1002	218			218			252			-	-	-
1003	266			266			300			-	-	-
1004	-	-	-	-	-	-	-	-	-	-	-	-

PL	IEC ~ Kg							
	63	71	80	90	100	112	132	160
1001	20	20	22	22	23	23	27	37
1002	26	26	28	28	29	29	33	-
1003	32	32	34	34	35	35	39	-
1004	38	38	40	40	-	-	-	-

**PL 1000 FS - Giriş Milleri / Input Shafts / Antriebswellen / Alberi Entrata / Arbres D'entree / Ejes De Entrada**

PL	EL C 28				EL C 42				EML 42				EML 1"3/8 Z6			
	L <sub>T</sub>	Z	L	Ød	L <sub>T</sub>	Z	L	Ød	L <sub>T</sub>	Z	L	Ød	L <sub>T</sub>	Z	L	Ød
1001	168	64	50	28	168	64	82	42	198	94	82	42	198	94	106	1"3/8
1002	216				216				246				246			
1003	264				264				294				294			
1004	312				312				342				342			

PL	~ Kg			
	EL C 28	EL C 42	EML 42	EML 1"3/8 Z6
1001	20.5	21.0	24.0	24.0
1002	26.5	27.0	30.0	30.0
1003	32.5	33.0	36.0	36.0
1004	38.5	39.0	42.0	42.0

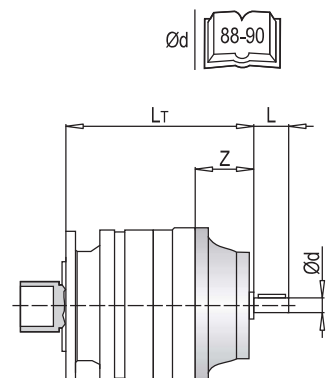
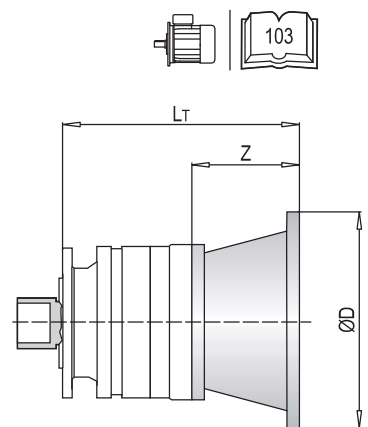

**PL 1000 FS - Sonsuz Dişlili Redüktör Adaptörleri (PMRV/PRV) / Worm Gearbox Adaptors (PMRV/PRV) / Anschluss Für Schneckengetriebe (PMRV/PRV) / Predisposizioni Per Riduttori A Vite Senza Fine (PMRV/PRV) / Adaptation Pour Reducteurs A Vis Sans Fin (PMRV/PRV) / Acoplamiento Para Reductores De Tornillo Sin Fin (PMRV/PRV)**

PL	PMRV/PRV 050					PMRV/PRV 063				
	L <sub>M</sub>	I	h	MA	G	L <sub>M</sub>	I	h	MA	G
1001	229.5	50	110	60	80	239	63	135	72	95
1002	277.5					287				
1003	325.5					335				
1004	373.5					383				

PL	PMRV/PRV 075					PMRV/PRV 090				
	L <sub>M</sub>	I	h	MA	G	L <sub>M</sub>	I	h	MA	G
1001	218	75	161	86	112.5	228	90	193	103	129.5
1002	266					276				
1003	314					324				
1004	362					372				

PL	PMRV/PRV ~ 			
	050	063	075	090
1001	23	26.5	29	34
1002	29	32.5	35	40
1004	35	38.5	41	46
1004	41	44.5	47	52

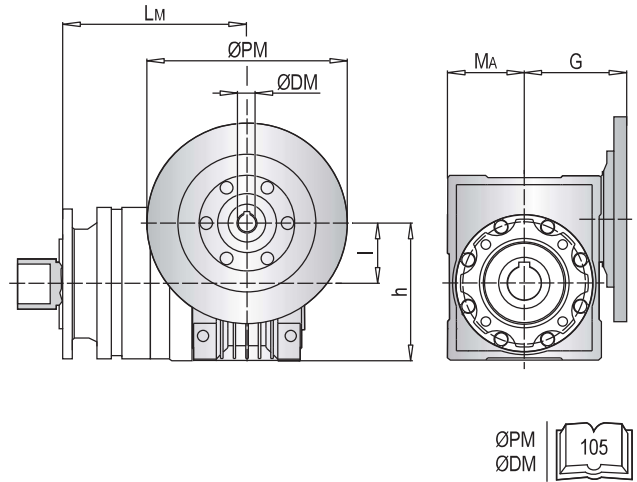

**PLB 1000 FS - Elektrik Motor Adaptörleri (IEC) / Electric Motor Couplings (IEC) / Anbauvorrichtung Für Elektromotore (IEC) / Predisposizioni Per Motori Elettrici (IEC) / Adaptations Pour Moteurs Electriques (IEC) / Acoplamientos Para Motores Eléctricos (IEC)**

PLB	IEC 80				IEC 90				IEC 100				IEC 112			
	A	L <sub>T</sub>	Z	ØD	A	L <sub>T</sub>	Z	ØD	A	L <sub>T</sub>	Z	ØD	A	L <sub>T</sub>	Z	ØD
1002	179	216	56	200	179	216	56	200	179	226	66	250	179	226	66	250
1003	227				227				227				227			
1004	275				275				-				-			

PLB	IEC 132			
	A	L <sub>T</sub>	Z	ØD
1002	179	260	100	300
1003	227			
1004	-			

PLB	IEC ~ 				
	80	90	100	112	132
1002	37	37	38	38	42
1003	43	43	44	44	48
1004	49	49	-	-	-

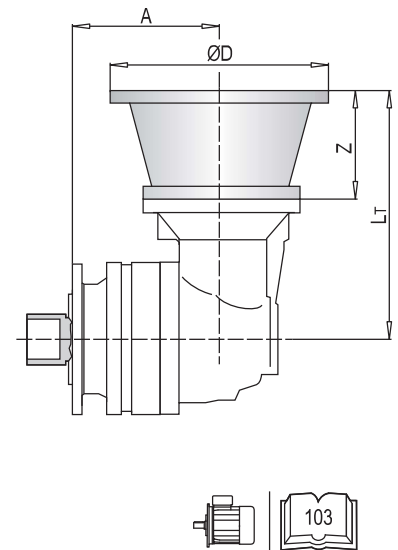

**PLB 1000 FS - Giriş Milleri / Input Shafts / Antriebswellen / Alberi Entrata / Arbres D'entree / Ejes De Entrada**

PLB	EL C 28					EL C 42					EML 42					EML 1"3/8 Z6				
	A	L <sub>T</sub>	Z	L	Ød	A	L <sub>T</sub>	Z	L	Ød	A	L <sub>T</sub>	Z	L	Ød	A	L <sub>T</sub>	Z	L	Ød
1002	179	224	64	50	28	179	224	64	82	42	179	254	94	82	42	179	254	94	106	1"3/8
1003	227					227					227					227				
1004	275					275					275					275				

PLB	~ 			
	EL C 28	EL C 42	EML 42	EML 1"3/8 Z6
1002	32.5	33.0	36.0	36.0
1003	38.5	39.0	42.0	42.0
1004	44.5	45.0	48.0	48.0

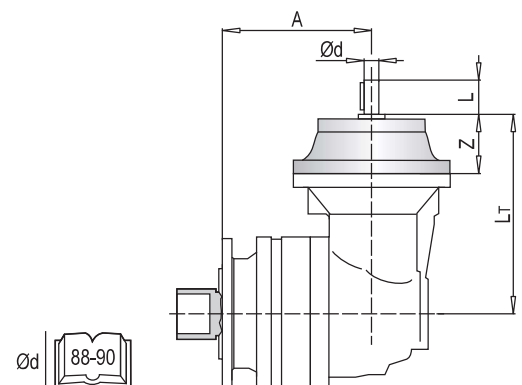

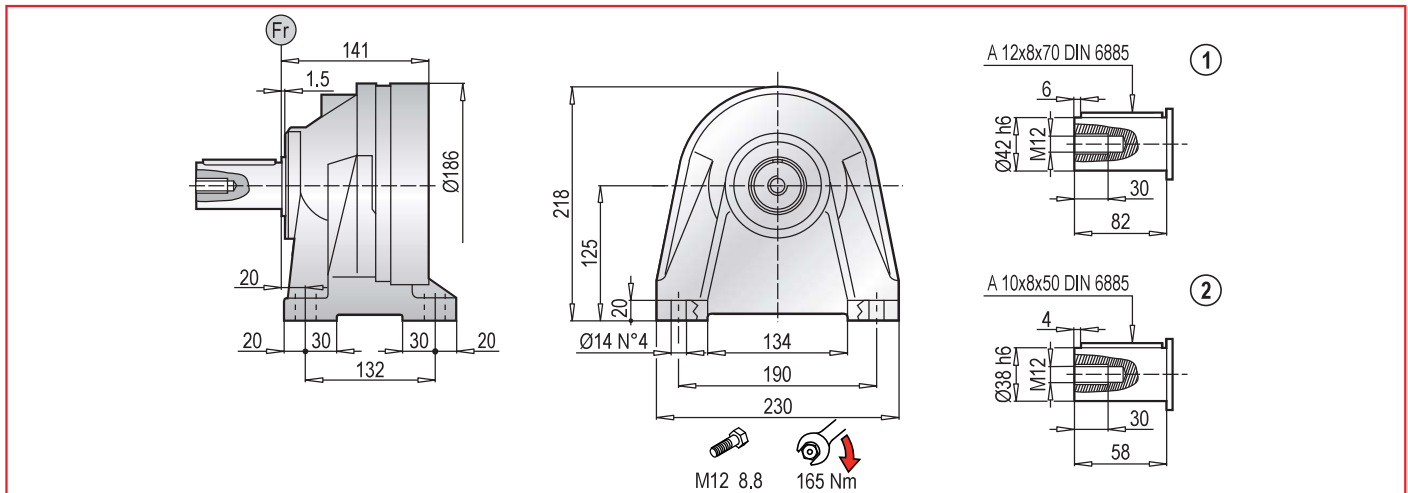

**PL 1000 CPC - Elektrik Motor Adaptörleri (IEC) / Electric Motor Couplings (IEC) / Anbauvorrichtung Für Elektromotore (IEC) / Predisposizioni Per Motori Elettrici (IEC) / Adaptations Pour Moteurs Electriques (IEC) / Acoplamientos Para Motores Eléctricos (IEC)**

PL	IEC 63			IEC 71			IEC 80			IEC 90		
	L <sub>T</sub>	Z	ØD	L <sub>T</sub>	Z	ØD	L <sub>T</sub>	Z	ØD	L <sub>T</sub>	Z	ØD
1001	177	36	140	177	36	160	197	56	200	197	56	200
1002	225			225			245			245		
1003	273			273			293			293		
1004	321			321			341			341		

PL	IEC 100			IEC 112			IEC 132			IEC 160		
	L <sub>T</sub>	Z	ØD	L <sub>T</sub>	Z	ØD	L <sub>T</sub>	Z	ØD	L <sub>T</sub>	Z	ØD
1001	207	66	250	207	66	250	241	100	300	280	139	350
1002	255			255			289			-	-	-
1003	303			303			337			-	-	-
1004	-	-	-	-	-	-	-	-	-	-	-	-

PL	IEC ~ Kg								
	63	71	80	90	100	112	132	160	
1001	24	24	26	26	27	27	31	41	
1002	30	30	32	32	33	33	37	-	
1003	36	36	38	38	39	39	43	-	
1004	42	42	44	44	-	-	-	-	

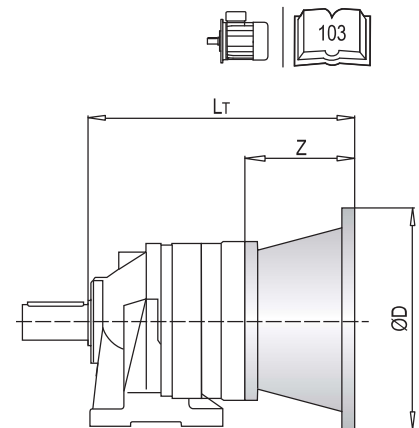

**PL 1000 CPC - Giriş Milleri / Input Shafts / Antriebswellen / Alberi Entrata / Arbres D'entree / Ejes De Entrada**

PL	EL C 28				EL C 42				EML 42				EML 1"3/8 Z6			
	L <sub>T</sub>	Z	L	Ød	L <sub>T</sub>	Z	L	Ød	L <sub>T</sub>	Z	L	Ød	L <sub>T</sub>	Z	L	Ød
1001	205	64	50	28	205	64	82	42	235	94	82	42	235	94	106	1"3/8
1002	253				253				283				283			
1003	301				301				331				331			
1004	349				349				379				379			

PL	~ Kg			
	EL C 28	EL C 42	EML 42	EML 1"3/8 Z6
1001	24.5	25.0	28.0	28.0
1002	30.5	31.0	34.0	34.0
1003	36.5	37.0	40.0	40.0
1004	42.5	43.0	46.0	46.0

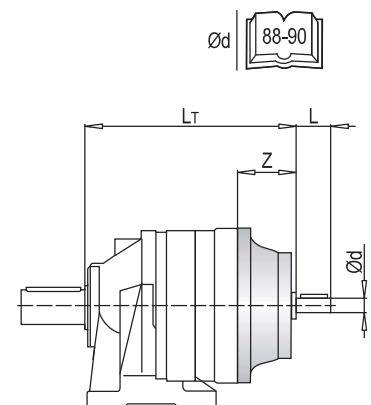



**PL 1000 CPC - Sonsuz Dişli Redüktör Adaptörleri (PMRV/PRV) / Worm Gearbox Adaptors (PMRV/PRV) / Anschluss Für Schneckengetriebe (PMRV/PRV) / Predisposizioni Per Riduttori A Vite Senza Fine (PMRV/PRV) / Adaptation Pour Reducteurs A Vis Sans Fin (PMRV/PRV) / Acoplamiento Para Reductores De Tornillo Sin Fin (PMRV/PRV)**

PL	PMRV/PRV 050					PMRV/PRV 063				
	L <sub>M</sub>	I	h	MA	G	L <sub>M</sub>	I	h	MA	G
1001	226.5	50	110	60	80	276	63	135	72	95
1002	314.5					324				
1003	362.5					472				
1004	410.5					420				

PL	PMRV/PRV 075					PMRV/PRV 090				
	L <sub>M</sub>	I	h	MA	G	L <sub>M</sub>	I	h	MA	G
1001	255	75	161	86	112.5	265	90	193	103	129.5
1002	303					313				
1003	351					361				
1004	399					409				

PL	PMRV/PRV ~ Kg			
	050	063	075	090
1001	27	30.5	33	38
1002	33	36.5	39	44
1004	39	42.5	45	50
1004	45	48.5	51	56

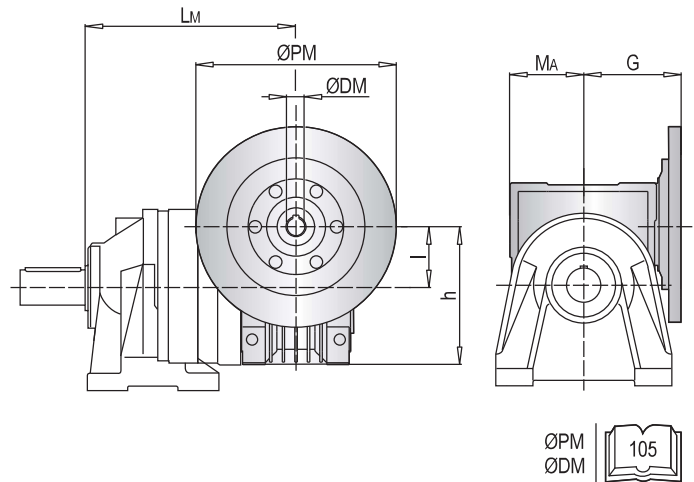

**PLB 1000 CPC - Elektrik Motor Adaptörleri (IEC) / Electric Motor Couplings (IEC) / Anbauvorrichtung Für Elektromotore (IEC) / Predisposizioni Per Motori Elettrici (IEC) / Adaptations Pour Moteurs Electriques (IEC) / Acoplamientos Para Motores Eléctricos (IEC)**

PLB	IEC 80				IEC 90				IEC 100				IEC 112			
	A	L <sub>T</sub>	Z	ØD	A	L <sub>T</sub>	Z	ØD	A	L <sub>T</sub>	Z	ØD	A	L <sub>T</sub>	Z	ØD
1002	216	216	56	200	216	216	56	200	216	226	66	250	216	226	66	250
1003	264				264				264				264			
1004	312				312				-				-			

PLB	IEC 132			
	A	L <sub>T</sub>	Z	ØD
1002	216	260	100	300
1003	264			
1004	-			

PLB	IEC ~ Kg				
	80	90	100	112	132
1002	41	41	42	42	46
1003	47	47	48	48	52
1004	53	53	-	-	-

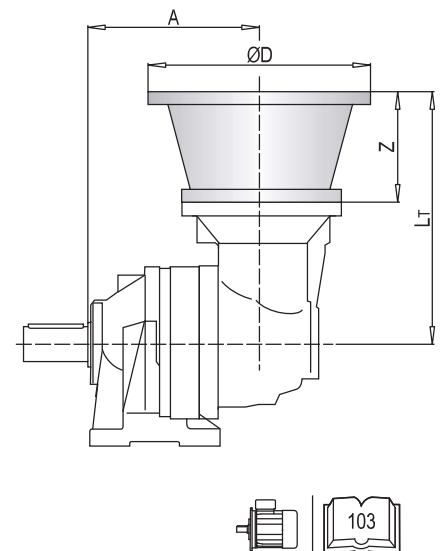

**PLB 1000 CPC - Giriş Milleri / Input Shafts / Antriebswellen / Alberi Entrata / Arbres D'entree / Ejes De Entrada**

PLB	EL C 28					EL C 42					EML 42					EML 1"3/8 Z6				
	A	L <sub>T</sub>	Z	L	Ød	A	L <sub>T</sub>	Z	L	Ød	A	L <sub>T</sub>	Z	L	Ød	A	L <sub>T</sub>	Z	L	Ød
1002	216	224	64	50	28	216	224	64	82	42	216	254	94	82	42	216	254	94	106	1"3/8
1003	264					264					264					264				
1004	312					312					312					312				

PLB	~ Kg			
	EL C 28	EL C 42	EML 42	EML 1"3/8 Z6
1002	39.5	40.0	43.0	43.0
1003	45.5	46.0	49.0	49.0
1004	51.5	52.0	55.0	55.0

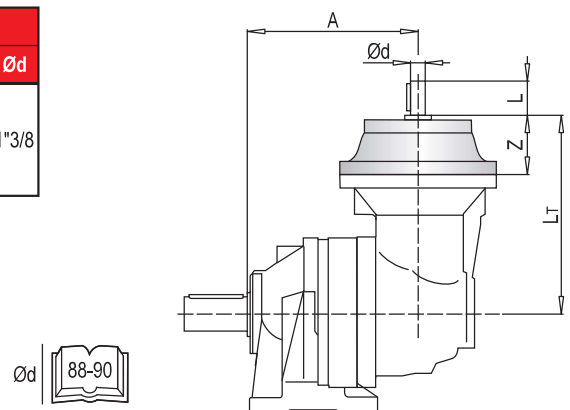

PL	~ Kg
1001	14
1002	20
1003	26
1004	32

PL	~ Kg
1001	14
1002	20
1003	26
1004	32

PL	~ Kg
1001	16
1002	22
1003	28
1004	34

PL	~ Kg
1001	16
1002	22
1003	28
1004	34

PL	~ Kg
1001	12
1002	18
1003	24
1004	30

PL	~ Kg
1001	15
1002	21
1003	27
1004	33

PL	~ Kg
1001	19
1002	25
1003	31
1004	37

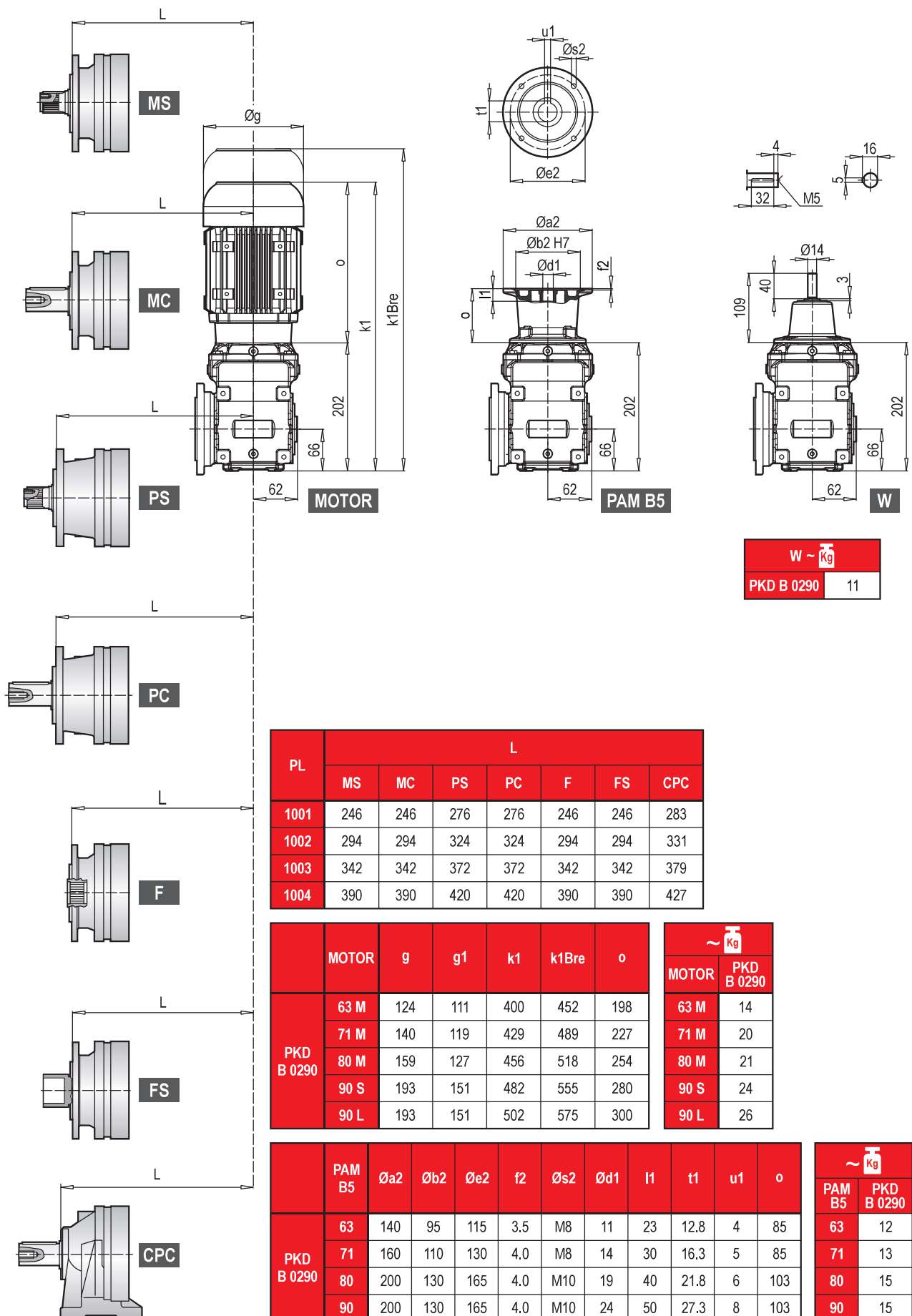

W ~ Kg
PKD B 0290 11

AKSESUARLAR / ACCESSORIES / ZUBEHÖR / ACCESSORI / ACCESSOIRES / ACCESORIOS

**YZ** Pinyon / Pinion / Ritzel  
Pignoni / Pignon / Piñones

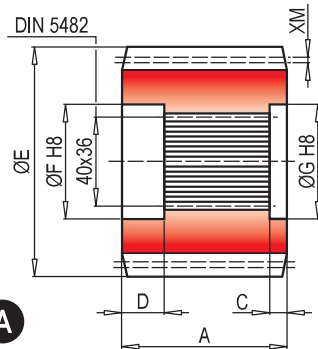

**A**

	Çıkış tipi Output type Abtriebs-version Version Versión	M	Z	XM	A	B	C	D	E	F	G	K	Malzeme Material Material Matière Material	Kod Code Bestell-Nr. Codice Code Código
<b>A</b>	M..-P..	1.9	20	0.049	65	-	6	20.5	84.5	42	42	-	38NiCrMo4	1071.200.042
	M..-P..	5	16	2.5	55	-	6	20.5	95	42	42	-	38NiCrMo4	1071.259.042
<b>B</b>	M..-P..	3.5	23	0	40	60.5	6	20.5	87.5	42	42	60	38NiCrMo4	1071.291.042

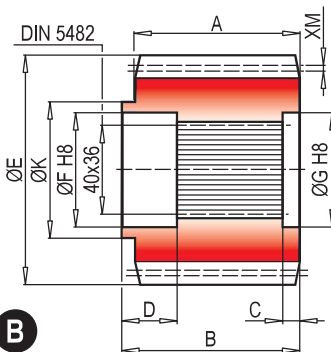

**B**

**FF** Sabitleme rondelası / Stop bottom plate / Endscheibe /  
Fondello di arresto / Bouchon de fermeture / Tapón de detención

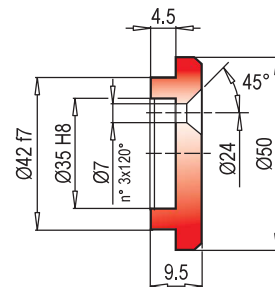

Kod / Code  
Bestell - Nr. / Codice  
Code / Código  
**1075.034.000**

**BS** Spline kaplin / Splined bushing / Innenverzahnte Buchse /  
Boccola scanalata / Moyeu cannelé / Casquillo ranurado

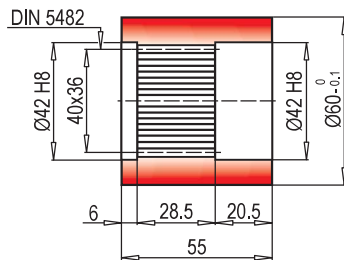

Malzeme / Material  
Material / Materiale  
Matière / Material  
UNI C40  
SAE 1040  
DIN Ck40

Kod / Code  
Bestell - Nr. / Codice  
Code / Código  
**0171.100.076**

**KB** Spline mil / Splined rod / Außenverzahnte Welle /  
Barra scanalata / Arbore cannelé / Barra ranurada

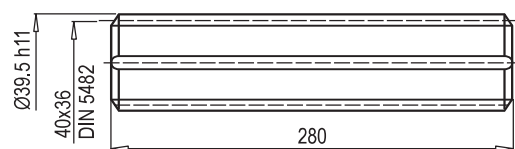

Malzeme / Material  
Material / Materiale  
Matière / Material

UNI 39NiCrMo3  
Sertleşmiş ve tavlanmış / Hardened and tempered  
Vergütet / Bonifié  
Bonificado / Endurecido e temperado

Kod / Code  
Bestell - Nr. / Codice  
Code / Código  
**3071.179.042**

**FL** Flanş / Flange / Flansch  
Flangia / Bride / Brida

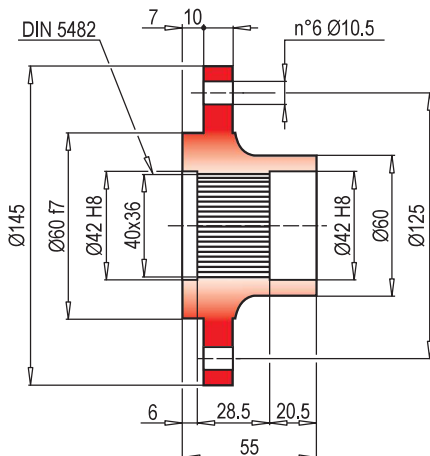

Kod / Code  
Bestell - Nr. / Codice  
Code / Código  
**0171.102.025**

**GA** Konik sıkırtma / Shrink disc / Schrumpfscheibe /  
Giunto di attrito / Frette de serrage / Disco de contracción

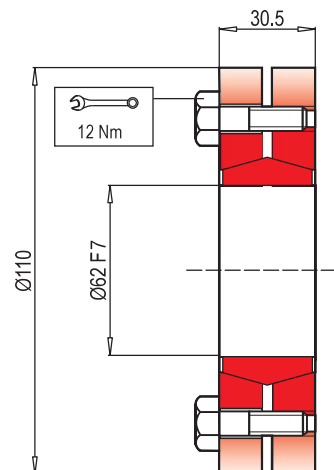

Maksimum moment  
Max. torque  
Max. Drehmoment  
Coppia max.  
Couple max.  
Momento máx.  
**2.2 kNm**

Kod / Code  
Bestell - Nr. / Codice  
Code / Código  
**5109.062.000**

TR

RADYAL YÜKLER (Fr)

Aşağıdaki grafikler istenilen  $n_2xh$  değerinin elde edilmesi için gerekli olan radyal yükleri ve K faktörlerini göstermektedir.

EN

RADIAL LOADS (Fr)

The following curves show the radial loads and the K factors to obtain the required  $n_2xh$  value.

DE

RADIALLAST (Fr)

In den nachstehenden Diagrammen ist die Radiallast und der Koeffizient K dargestellt und kann mit dem gewünschten Wert  $n_2xh$  verglichen werden.

IT

CARICHI RADIALI (Fr)

Nei diagrammi seguenti sono riportati i carichi radiali e i coefficienti K per rapportarli al valore  $n_2xh$  desiderato.

FR

CHARGES RADIALES (Fr)

Dans les diagrammes suivants sont indiqués les charges radiales et les facteurs K de façon à obtenir la valeur  $n_2xh$  désirée.

ES

CARGAS RADIALES (Fr)

En los siguientes diagramas se indican las cargas radiales y los coeficientes K para obtener el valor requerido  $n_2xh$ .

**M - P - CPC\***

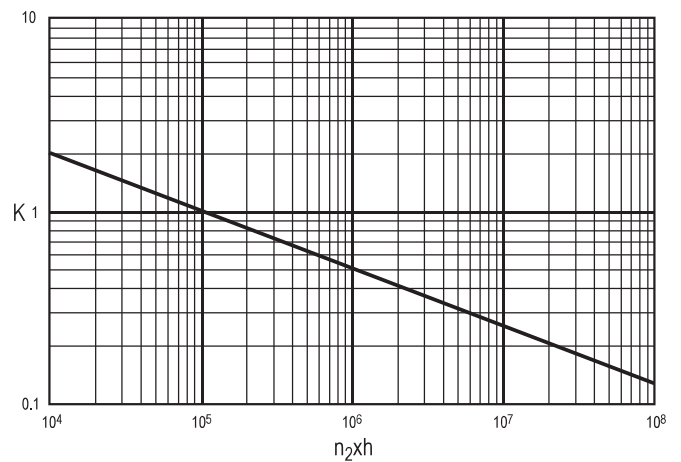
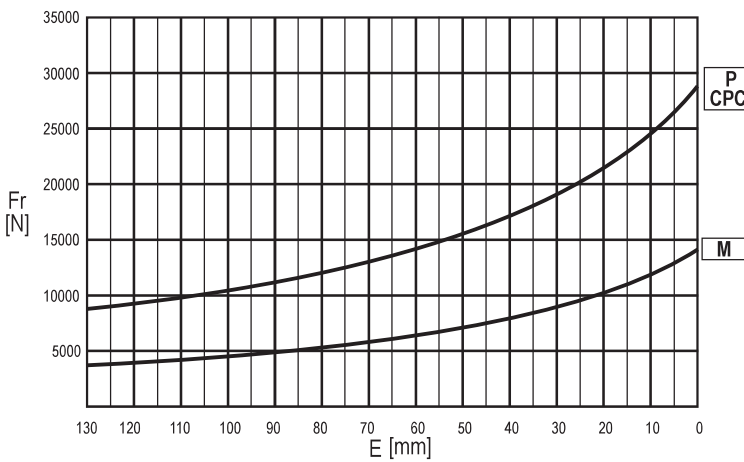

	n x h				
	10 <sup>5</sup>	10 <sup>4</sup>	10 <sup>6</sup>	10 <sup>7</sup>	10 <sup>8</sup>
<b>M - P</b>	Fr		Fr • K		
<b>CPC*</b>	Fr • 0.75		Fr • K • 0.75		

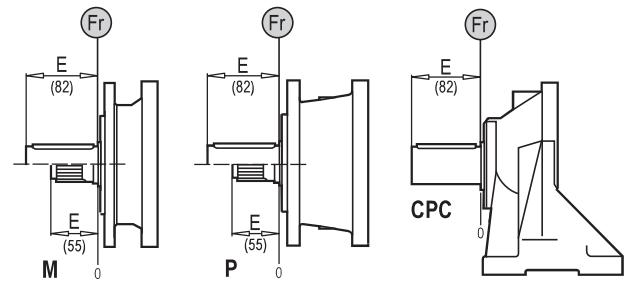

TR

EKSENEL YÜKLER (Fa)

Tabloda yer alan eksenel yük değerleri, çıkış tipine ve uygulamanın yük yönüne göre değişir.

EN

AXIAL LOADS (Fa)

The values of the axial loads in the table refer to the output versions and load direction of application.

DE

AXIALLAST (Fa)

Die dargestellten Werte der Axiallast basieren auf der Version und der applizierten Lastrichtung.

IT

CARICHI ASSIALI (Fa)

I valori dei carichi assiali indicati in tabella sono riferiti alle versioni e alla direzione di applicazione del carico.

FR

CHARGES AXIALES (Fa)

Les valeurs des charges axiales indiquées dans le tableau se réfèrent aux versions et à la direction d'application de la charge.

ES

CARGAS AXIALES (Fa)

Los valores de las cargas axiales indicados en la tabla se refieren a las versiones y a la dirección de aplicación de la carga.

Fa [N]	M	P - CPC	
	16000	18000	
	16000	18000	←
			→

