

Planetary Gear Units PL/PLB Series

Technic Selection	
Type	PL
Input Option	Without Motor
Assembly Shaft Design	CPC (WITH KEY, SOLID SHAFT)
Body Size	7003
FA Press [N]	60000
FA Pull [N]	40000
FR [N]	45281
Frequency [Hz]	50
fs	0.9
iges	155.4
Lifetime Expection	10000
M2 [Nm]	5239
M2max [Nm]	4477
Motor Efficiency	IE3
Motor Size	132/4P
n1 [rpm]	1400
n2 [rpm]	9
P1 [kW]	5.5
P1max [kW]	4.7
Pt Indoor (10°C) [kW]	8.1
Pt Outdoor (10°C) [kW]	15.4
Pt Indoor (20°C) [kW]	7.4
Pt Outdoor (20°C) [kW]	14
Pt Indoor (30°C) [kW]	5.9
Pt Outdoor (30°C) [kW]	11.2
Pt Indoor (40°C) [kW]	5.2
Pt Outdoor (40°C) [kW]	9.8
Pt Indoor (50°C) [kW]	4.4
Pt Outdoor (50°C) [kW]	8.4

Variation	
Input Connection Size	IEC-132-A
Output Shaft Diameter	∅DxL=∅80h6x130[mm]
Input Connection Type	IEC
Input Backstop Status	Without Backstop
Mounting Position	B3

Option	
Oil Status	Exist
Oil Type	Synthetic ISO VG 320
Vent Plug	Standard
Oil Indicator Plug	None
Product Label	Standard
Color	RAL 7000
Montage Position Status	Standard
Amount Of Oil [Liter]	8,00
Case Material	GGG-50
Output Oil Seal Type	NBR
Output Bearing Quality	Standard



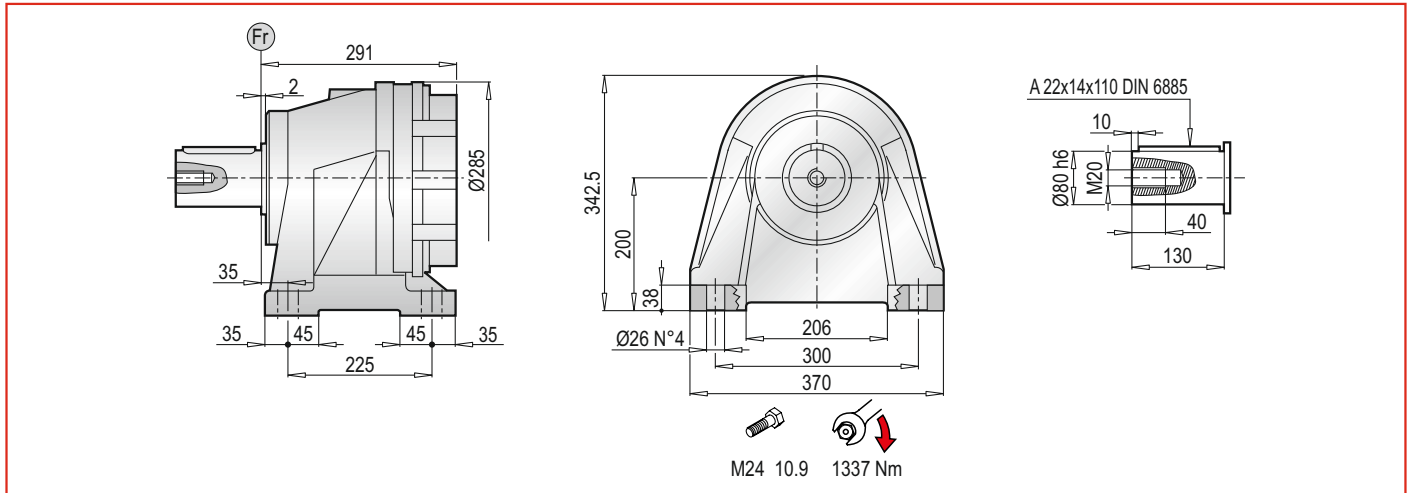

PL 7000 CPC - Elektrik Motor Adaptörleri (IEC) / Electric Motor Couplings (IEC) / Anbauvorrichtung Für Elektromotore (IEC) / Predisposizioni Per Motori Elettrici (IEC) / Adaptations Pour Moteurs Electriques (IEC) / Acoplamientos Para Motores Eléctricos (IEC)

PL	IEC 63			IEC 71			IEC 80			IEC 90			IEC 100		
	L _T	Z	ØD	L _T	Z	ØD	L _T	Z	ØD	L _T	Z	ØD	L _T	Z	ØD
7001	-	-	-	-	-	-	-	-	-	-	-	-	-	-	-
7002	386.5	-	-	386.5	-	-	406.5	-	-	406.5	-	-	416.5	-	-
7003	434.5	36	140	434.5	36	160	454.5	56	200	454.5	56	200	464.5	66	250
7004	482.5	-	-	482.5	-	-	502.5	-	-	502.5	-	-	512.5	-	-

PL	IEC 112			IEC 132			IEC 160			IEC 180			IEC 200		
	L _T	Z	ØD	L _T	Z	ØD	L _T	Z	ØD	L _T	Z	ØD	L _T	Z	ØD
7001	-	-	-	-	-	-	409	118	350	409	118	350	439	148	400
7002	416.5	-	-	450.5	-	-	489.5	-	-	489.5	139	350	-	-	-
7003	464.5	66	250	498.5	100	300	537.5	139	350	-	-	-	-	-	-
7004	512.5	-	-	546.5	-	-	-	-	-	-	-	-	-	-	-

PL	IEC ~ Kg									
	63	71	80	90	100	112	132	160	180	200
7001	-	-	-	-	-	-	-	106	106	116
7002	101	101	103	103	104	104	108	118	118	-
7003	108	108	110	110	111	111	115	125	-	-
7004	114	114	116	116	117	117	121	-	-	-

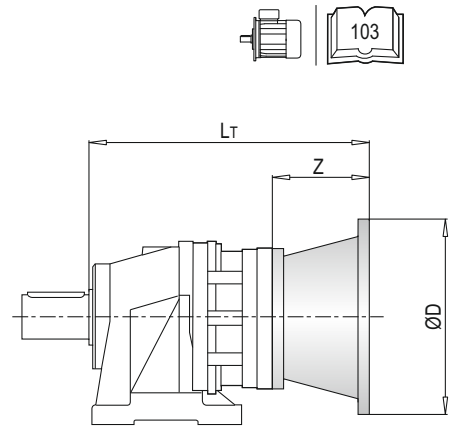

PL 7000 CPC - Giriş Milleri / Input Shafts / Antriebswellen / Alberi Entrata / Arbres D'entree / Ejes De Entrada

PL	EL C 28				EL C 42				EML 42				EML 1"3/8 Z6				EM 65				EM 1"3/8 Z6			
	L _T	Z	L	Ød	L _T	Z	L	Ød	L _T	Z	L	Ød	L _T	Z	L	Ød	L _T	Z	L	Ød	L _T	Z	L	Ød
7001	-	-	-	-	-	-	-	-	-	-	-	-	-	-	-	-	412.5	121.5	105	65	412.5	121.5	105	1"3/8
7002	414.5	-	-	-	414.5	-	-	-	444.5	-	-	-	444.5	-	-	-	485.5	-	-	-	485.5	-	-	-
7003	462.5	64	50	28	462.5	64	82	42	492.5	94	82	42	492.5	94	106	1"3/8	-	-	-	-	-	-	-	-
7004	510.5	-	-	-	510.5	-	-	-	540.5	-	-	-	540.5	-	-	-	-	-	-	-	-	-	-	-

PL	EP 65				PL	~ Kg						
	L _T	Z	L	Ød		EL C 28	EL C 42	EML 42	EML 1"3/8 Z6	EM 65	EM 1"3/8 Z6	EP 65
7001	444	-	-	-	7001	-	-	-	-	101.0	101.0	110.0
7002	517	153	105	65	7002	101.5	102.0	105.0	105.0	113.0	113.0	122.0
7003	-	-	-	-	7003	108.5	109.0	112.0	112.0	-	-	-
7004	-	-	-	-	7004	114.5	115.0	118.0	118.0	-	-	-

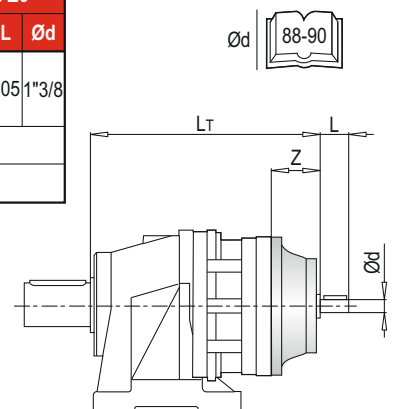

PL 7000 CPC - Sonsuz Dişli Redüktör Adaptörleri (PMRV/PRV) / Worm Gearbox Adaptors (PMRV/PRV) / Anschluss Für Schneckengetriebe (PMRV/PRV) / Predisposizioni Per Riduttori A Vite Senza Fine (PMRV/PRV) / Adaptation Pour Reducteurs A Vis Sans Fin (PMRV/PRV) / Acoplamiento Para Reductores De Tornillo Sin Fin (PMRV/PRV)

PL	PMRV/PRV 050					PMRV/PRV 063					PMRV/PRV 075				
	Lm	l	h	MA	G	Lm	l	h	MA	G	Lm	l	h	MA	G
7001	-					-					-				
7002	476					485.5					464.5				
7003	524	50	110	60	80	533.5	63	135	72	95	512.5	75	161	86	112.5
7004	572					571.5					560.5				

PL	PMRV/PRV 090					PMRV/PRV 110					PMRV/PRV 130				
	Lm	l	h	MA	G	Lm	l	h	MA	G	Lm	l	h	MA	G
7001	-					429	110	237.5	127.5	160	436.5	130	277.5	147.5	180
7002	474.5					502					509.5				
7003	522.5	90	193	103	129.5	-					-				
7004	570.5					-					-				

PL	PMRV/PRV ~ Kg					
	050	063	075	090	110	130
7001	-	-	-	-	130	147
7002	104	107.5	110	115	142	159
7003	111	114.5	117	122	-	-
7004	117	120.5	123	128	-	-

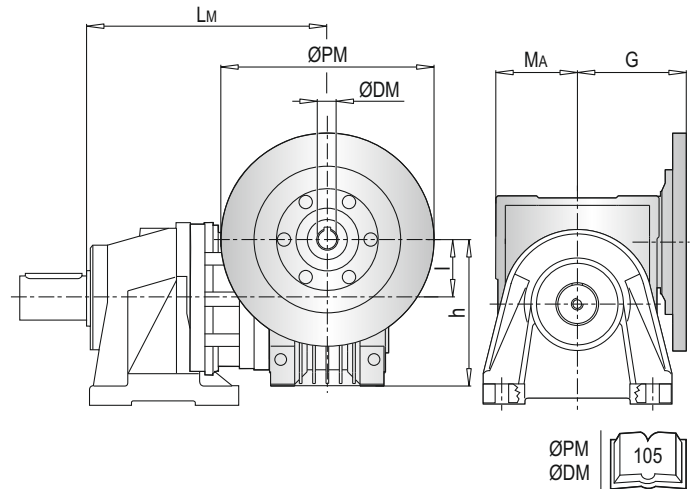

PLB 7000 CPC - Elektrik Motor Adaptörleri (IEC) / Electric Motor Couplings (IEC) / Anbauvorrichtung Für Elektromotore (IEC) / Predisposizioni Per Motori Elettrici (IEC) / Adaptations Pour Moteurs Electriques (IEC) / Acoplamientos Para Motores Eléctricos (IEC)

PLB	IEC 80				IEC 90				IEC 100				IEC 112				IEC 132			
	A	Lt	Z	ØD	A	Lt	Z	ØD	A	Lt	Z	ØD	A	Lt	Z	ØD	A	Lt	Z	ØD
7002	379	296			379	296			379	306			379	306			379	340		
7003	425.5	216	56	200	425.5	216	56	200	425.5	226	66	250	425.5	226	66	250	425.5	260	100	300
7004	473.5				473.5				473.5				473.5				473.5			

PLB	IEC 160				IEC 180			
	A	Lt	Z	ØD	A	Lt	Z	ØD
7002	379	379	139	350	379	379	139	350
7003	425.5	299			-			
7004	-				-			

PLB	IEC ~ Kg							
	80	90	100	112	132	160	180	
7002	129	129	130	130	134	144	144	
7003	119	119	120	120	124	134	-	
7004	125	125	126	126	130	-	-	

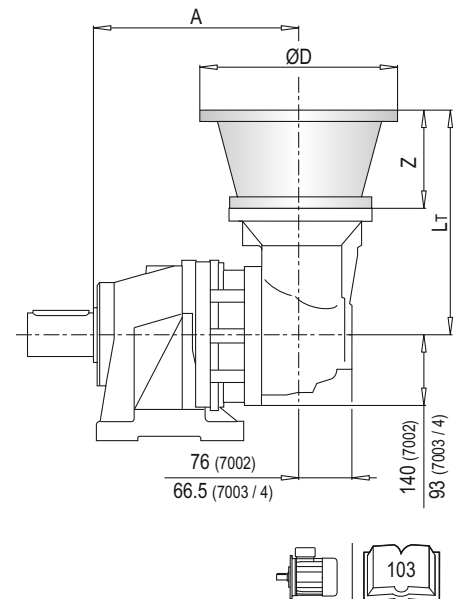

PLB 7000 CPC - Giriş Milleri / Input Shafts / Antriebswellen / Alberi Entrata / Arbres D'entree / Ejes De Entrada

PLB	EL C 28					EL C 42					EML 42					EML 1"3/8 Z6					EM 65				
	A	Lt	Z	L	Ød	A	Lt	Z	L	Ød	A	Lt	Z	L	Ød	A	Lt	Z	L	Ød	A	Lt	Z	L	Ød
7002	379	304				379	304				379	334				379	334				379	377.5			
7003	425.5	224	64	50	28	425.5	224	64	82	42	425.5	254	94	82	42	425.5	254	94	106	1"3/8	425.5	297.5	121.5	105	65
7004	473.5					473.5					473.5					473.5					473.5				

PLB	EM 1"3/8 Z6					EP 65				
	A	Lt	Z	L	Ød	A	Lt	Z	L	Ød
7002	379	377.5				379	409			
7003	425.5	297.5	121.5	105	1"3/8	425.5	329	153	105	65
7004	473.5					473.5				

PLB	~ Kg							
	EL C 28	EL C 42	EML 42	EML 1"3/8 Z6	EM 65	EM 1"3/8 Z6	EP 65	
7002	127.5	128.0	131.0	131.0	139.0	139.0	148.0	
7003	117.5	118.0	121.0	121.0	129.0	129.0	128.0	
7004	123.5	124.0	127.0	127.0	135.0	135.0	144.0	

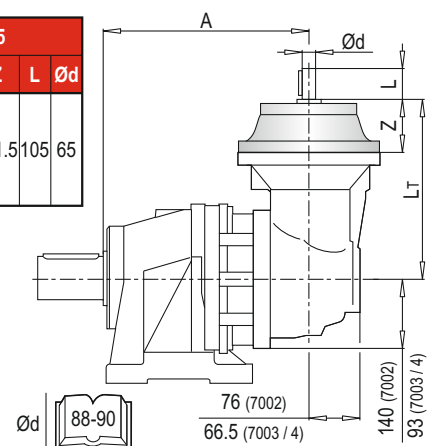

TR ELEKTRİK MOTOR ADAPTÖRLERİ

EN ELECTRIC MOTOR COUPLINGS

DE ANBAUVORRICHTUNG FÜR ELEKTROMOTORE

IT PREDISPOSIZIONI PER MOTORI ELETTRICI

FR ADAPTATIONS POUR MOTEURS ELECTRIQUES

ES ACOPLAMIENTOS PARA MOTORES ELÉCTRICOS

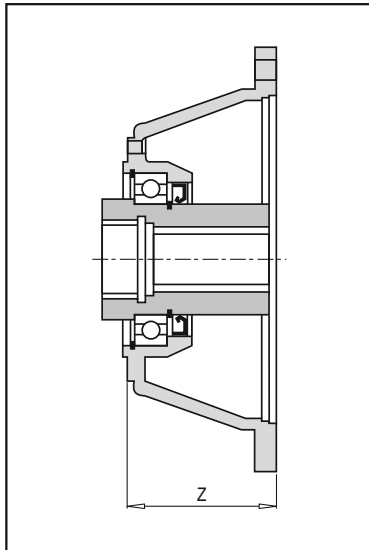

UNEL/IEC B5			
	Z	Kod / Code Bestell Nr. / Codice Code / Código	
H63	36	2074.011.005	A
H71	36	2074.011.006	
H80	56	2074.011.001	
H90	56	2074.011.002	
H100/112	66	2074.011.003	
H132	100	2074.011.004	
H160	139	2074.011.047	B
H180	139	2074.011.048	
H160	118	2074.051.001	
H180	118	2074.051.002	
H200	148	2074.051.015	
H225	139	2074.051.016	
H250	148.5	2074.051.024	C
H280	148.5	2074.051.025	
H160	150	2074.071.001	
H180	150	2074.071.002	
H200	150	2074.071.003	
H225	139	2074.071.004	
H250	139	2074.071.005	D
H280	139	2074.071.006	
H160	150	2074.081.001	
H180	150	2074.081.002	
H200	150	2074.081.003	
H225	139	2074.081.004	
H250	139	2074.081.005	
H280	139	2074.081.006	

NEMA C			
	Z	Kod / Code Bestell Nr. / Codice Code / Código	
143TC-145TC 182TC-184TC	80	2074.011.008	A
182TC-184TC 213TC-215TC	88.5	2074.011.009	
213TC-215TC	88.5	2074.011.010	
286TC	139	2074.051.006	B
326TC	149	2074.051.007	
365TS	149	2074.051.010	

Z ölçüleri tablodan doğrulanmalıdır.
Z dimensions have to be verified in the tables
Das Mass Z wird in den entsprechenden Tabellen auf der festgestellt.
Le dimensioni Z riportate vanno verificate con le tabelle.
Les dimensions de Z sont à vérifier dans les tableaux.
Las dimensiones Z indicadas tienen que verificarse con la tabla.

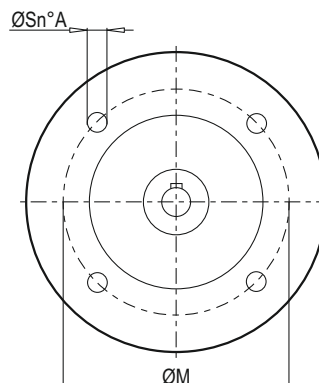
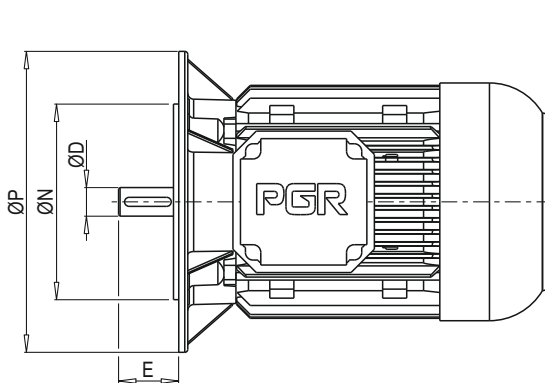

63...200

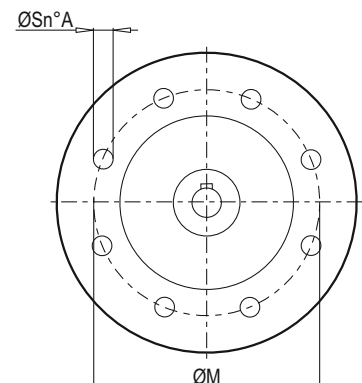

225...280

Kutup sayısı - Number of poles - Anzahl Pole N° poli - Numero poles - N° de polos	2								4		6		ØD	E	ØP	ØM	ØN	ØS	A
	2		4		6														
	[kW]	[kW]	[kW]	[kW]	[kW]	[kW]	[kW]	[kW]											
63	0.18		0.25	0.12		0.18	0.06		0.09			11	23	140	115	95	9.5	4	
71	0.37		0.55	0.25		0.37	0.18		0.25			14	30	160	130	110	9.5	4	
80	0.75		1.1	0.55		0.75	0.37		0.55			19	40	200	165	130	11.5	4	
90	1.5		2.2	1.1		1.5	0.75		1.1			24	50	200	165	130	11.5	4	
100/112	3		4	2.2	3	4	1.5		2.2			28	60	250	215	180	14	4	
132	5.5		7.5	5.5		7.5	3	4	5.5			38	80	300	265	230	14	4	
160	11	15	18.5	11		15	7.5		11			42	110	350	300	250	18	4	
180	22		18.5			22	15					48	110	350	300	250	18	4	
200	30		37	30		18.5			22			55	110	400	350	300	18	4	
225	45		37			45	30					60 (55-2p)	140	450	400	350	18	8	
250	55		55			37						65 (60-2p)	140	550	500	450	18	8	
280	75		90	75		90	45		55			75 (65-2p)	140	550	500	450	18	8	

TR

RADYAL YÜKLER (Fr)

Aşağıdaki grafikler istenilen n_2xh değerinin elde edilmesi için gerekli olan radyal yükleri ve K faktörlerini göstermektedir.

EN

RADIAL LOADS (Fr)

The following curves show the radial loads and the K factors to obtain the required n_2xh value.

DE

RADIALLAST (Fr)

In den nachstehenden Diagrammen ist die Radiallast und der Koeffizient K dargestellt und kann mit dem gewünschten Wert n_2xh verglichen werden.

IT

CARICHI RADIALI (Fr)

Nei diagrammi seguenti sono riportati i carichi radiali e i coefficienti K per rapportarli al valore n_2xh desiderato.

FR

CHARGES RADIALES (Fr)

Dans les diagrammes suivants sont indiqués les charges radiales et les facteurs K de façon à obtenir la valeur n_2xh désirée.

ES

CARGAS RADIALES (Fr)

En los siguientes diagramas se indican las cargas radiales y los coeficientes K para obtener el valor requerido n_2xh .

P - CPC*

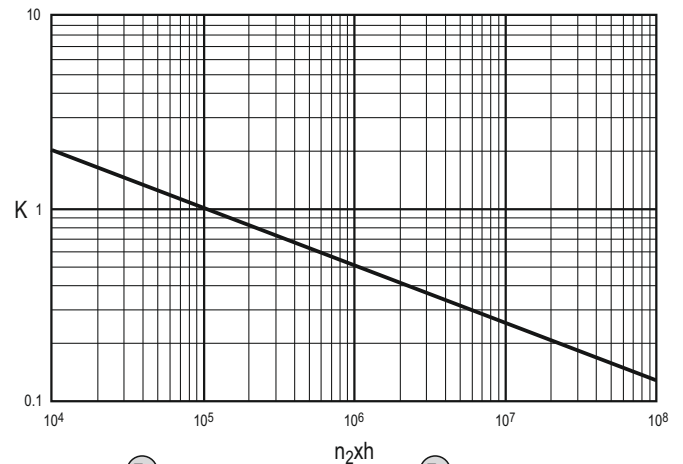
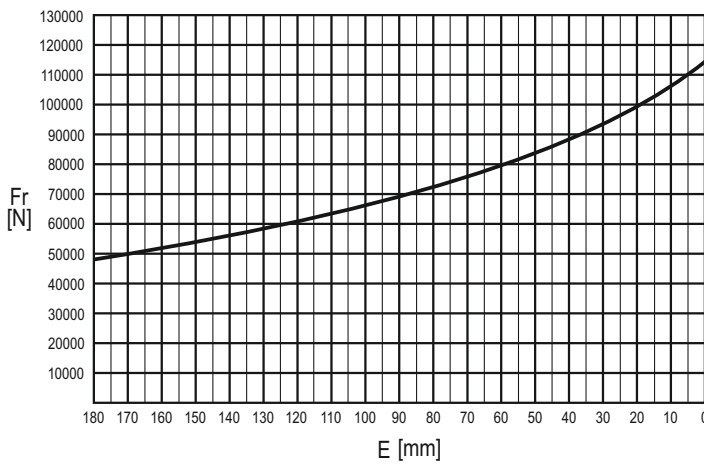

	$n \times h$				
	10^5	10^4	10^6	10^7	10^8
P	Fr			Fr • K	
CPC*	Fr • 0.75			Fr • K • 0.75	

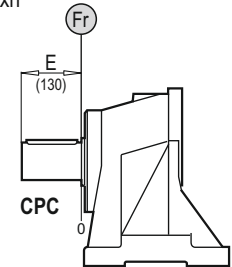
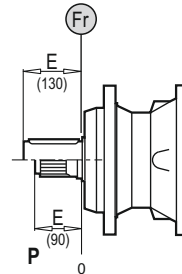

TR

EKSENEL YÜKLER (Fa)

Tabloda yer alan eksenel yük değerleri, çıkış tipine ve uygulamanın yük yönüne göre değişir.

EN

AXIAL LOADS (Fa)

The values of the axial loads in the table refer to the output versions and load direction of application.

DE

AXIALLAST (Fa)

Die dargestellten Werte der Axiallast basieren auf der Version und der applizierten Lastrichtung.

IT

CARICHI ASSIALI (Fa)

I valori dei carichi assiali indicati in tabella sono riferiti alle versioni e alla direzione di applicazione del carico.

FR

CHARGES AXIALES (Fa)

Les valeurs des charges axiales indiquées dans le tableau se réfèrent aux versions et à la direction d'application de la charge.

ES

CARGAS AXIALES (Fa)

Los valores de las cargas axiales indicados en la tabla se refieren a las versiones y a la dirección de aplicación de la carga.

Fa [N]	P	CPC	← →
	40000	40000	
60000		60000	

