

## Three-Phase-Asynchronous-Motor ACA 71 B 6

AC07B6300003

### General data

Kind of motor	3~
Type designation	ACA
Frame size	71
Mounting form	B3
Frame material	Aluminium
Insulation class	F/B
Terminal box location	top DE
Terminal box orientation	0° cable gland right side
Weight (kg)	6,70
Rotation Direction	right /left
Vibration level	A
Balancing method	half key
cooling type	IC411
Executed acc. to noise level	IEC 60034-1 IEC 60034-9

### Electrical data

Power 1 50Hz (kW)	0,25
Power 1 60Hz (kW)	0,30
Frequency (Hz)	50/60
Voltage 50Hz (V)	220-240/380-420
Voltage 60Hz (V)	220-280/380-480
Voltage/Frequency tolerance (not valid for range voltage)	range B
Connection	Δ/Y
Poles	6
Efficiency 100% 50Hz (%)	60,0
Efficiency 100% 60Hz (%)	60,0
Power factor	0,68
Starting current (Ia/In)	4
Starting torque (Ma/Mn)	1,9
Breakdown torque (Mk/Mn)	2
Current 50Hz (A)	1,54/0,88
Current 60Hz (A)	1,70/0,99

### Motor characteristics

Color	RAL7030
Paint surface	silk-gloss
Protection class	IP55
Cable gland size (cable connection)	1xM20x1,5 1xblind plug
Cable gland type	Standard
Shaft end (mm)	14 x 30
Shaft material	C45
Specification NDE	Plastic fan

### Mechanical data

Torque (Nm)	2,65/2,65
Rotation speed (1/min)	900/1080
Bearing DE	6202.ZZ.C3
Bearing NDE	6202.ZZ.C3
Mounting of bearing DE	loose bearing
Mounting of bearing NDE	loose bearing
Bearing lifetime (h)	20000
allow. Radial load (X/2) (N)	487
allow. Radial load (X0) (N)	525
allow. Radial load (Xmax) (N)	450
allow. Axial load (N)	475
allow. Axial load (V1) (N)	450
Moment of inertia (kgm <sup>2</sup> )	0,00055

### Influencing factors

Duty	S1
Ambient temperature (°C)	-20 up to +40
Height of location (m)	1000

Technical changes and errors reserved.

14.02.2019

## Drawings

### Three-Phase-Asynchronous-Motor ACA 71 B 6 AC07B6300003

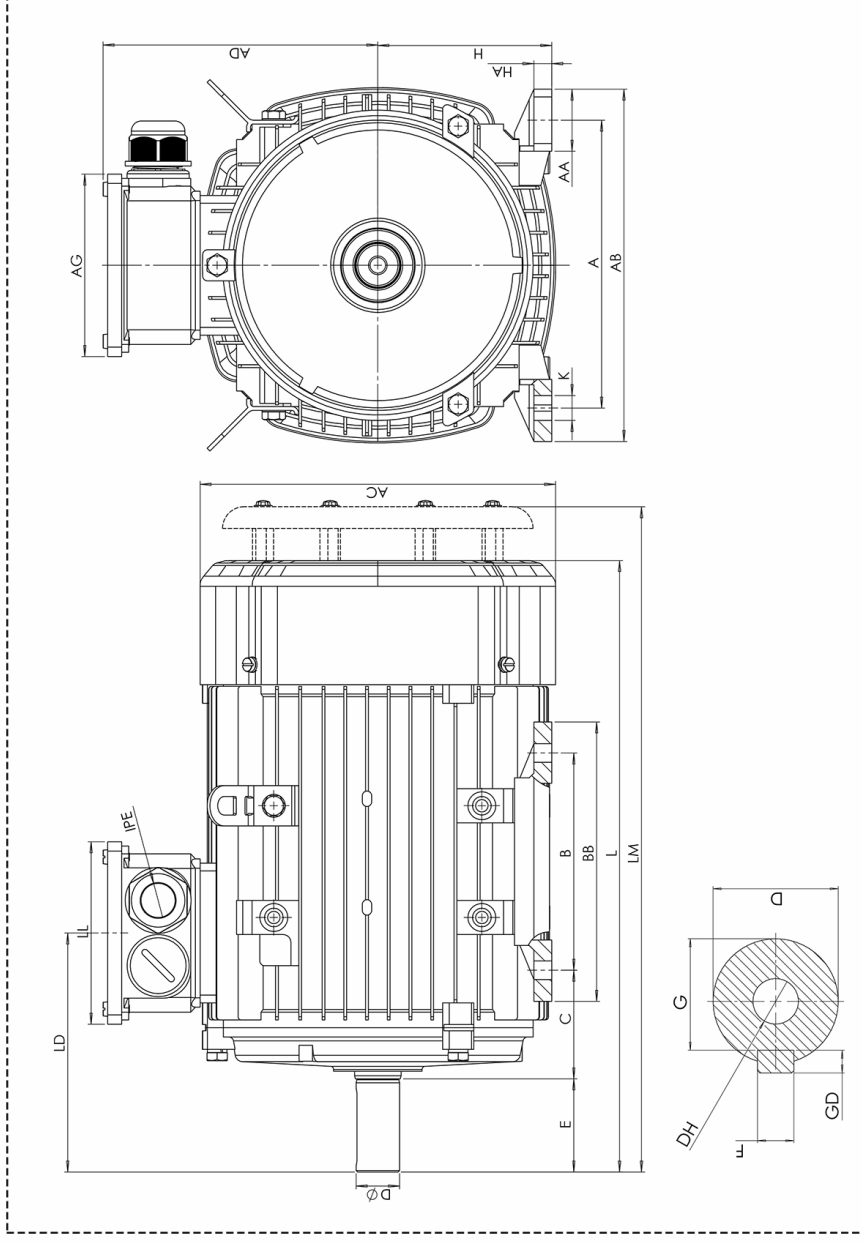

LM	275	IPE/KK	M20x1,5	DH	M5x12	K	7x11	ED	2,50	G	11,00	LL	101,00	LD	111,00	L	245,00	AG	101,00	GD	5	EB	25	F	5	HA	8	H	71	E	30	D	14	C	45	BB	110	B	90	AD	109	AC	136	AB	138	AA	26	A	112
----	-----	--------	---------	----	-------	---	------	----	------	---	-------	----	--------	----	--------	---	--------	----	--------	----	---	----	----	---	---	----	---	---	----	---	----	---	----	---	----	----	-----	---	----	----	-----	----	-----	----	-----	----	----	---	-----